

Operating instructions CD Clock Radio

Model No. **RC-CD350**

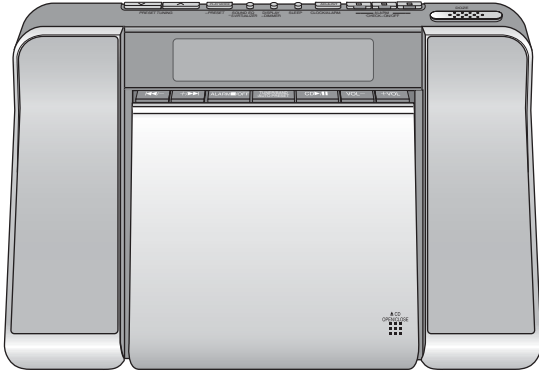

Matsushita Electric Industrial Co., Ltd.
Web Site: <http://www.panasonic.co.jp/global/>

EB GN En
RQT7608-B
H0204ZZ0

Supplied accessories

1 loop antenna: RSA0031

Use the numbers indicated when asking for replacement parts.

For the United Kingdom and Republic of Ireland

shop@ **Panasonic**

www.panasonic.co.uk (for UK customers only)

- Order accessory and consumable items for your product with ease and confidence by telephoning our Customer Care Centre Mon-Friday 9:00am-5:30pm. (Excluding public holidays.)
- Or go on line through our Internet Accessory ordering application.
- Most major credit and debit cards accepted.
- All enquiries transactions and distribution facilities are provided directly by Panasonic UK Ltd.
- It couldn't be simpler!

Customer Care Centre
For UK customers: 08705 357357
For Republic of Ireland customers: 01 289 8333

Technical Support
For UK customers: 0870 1 505610
This Technical Support Hot Line number is for Panasonic PC software related products only.
For Republic of Ireland, please use the Customer Care Centre number listed above for all enquiries.
For all other product related enquiries, please use the Customer Care Centre numbers listed above.

Troubleshooting guide

Before requesting service, make the below checks. If you are in doubt about some of the check points, or if the remedies indicated in the chart do not solve the problem, consult your dealer for instructions.

The clock shows “-:-”.	<ul style="list-style-type: none"> • Set the clock.
There is a lot of noise.	<ul style="list-style-type: none"> • Keep away from mobile phones, televisions, and other tuners. • Extend and change the direction of the antenna.
The alarm doesn't sound at the set time.	<ul style="list-style-type: none"> • Ensure the alarm's indicator is on (“ALARM 1”, “ALARM 2”, or “ALARM 3”).
The memory has been cleared.	<ul style="list-style-type: none"> • Reset the items into the memory. • Insert a battery to preserve the memory contents.
“no DISC” appears.	<ul style="list-style-type: none"> • You haven't inserted a CD.
Play doesn't start or display is incorrect.	<ul style="list-style-type: none"> • Clean the CD. • Clean the lens with a blower (SZZP1038C recommended). If the lens gets marked with fingerprints, gently wipe them off with a cotton swab. • Wait an hour for condensation to dry, then try again. • Make sure the label is facing out. • Replace the CD if it is scratched, warped, or irregularly shaped.
The CD or radio display disappears.	<ul style="list-style-type: none"> • These displays disappear after a few seconds. To show them again, press [DISPLAY, -DIMMER].

Caution for AC Mains Lead

CAUTION!

THIS PRODUCT UTILIZES A LASER.
USE OF CONTROLS OR ADJUSTMENTS OR PERFORMANCE OF PROCEDURES OTHER THAN THOSE SPECIFIED HEREIN MAY RESULT IN HAZARDOUS RADIATION EXPOSURE.
DO NOT OPEN COVERS AND DO NOT REPAIR YOURSELF. REFER SERVICING TO QUALIFIED PERSONNEL.

CAUTION!

- DO NOT INSTALL OR PLACE THIS UNIT IN A BOOKCASE, BUILT-IN CABINET OR IN ANOTHER CONFINED SPACE. ENSURE THE UNIT IS WELL VENTILATED. TO PREVENT RISK OF ELECTRIC SHOCK OR FIRE HAZARD DUE TO OVERHEATING, ENSURE THAT CURTAINS AND ANY OTHER MATERIALS DO NOT OBSTRUCT THE VENTILATION VENTS.
- DO NOT OBSTRUCT THE UNIT'S VENTILATION OPENINGS WITH NEWSPAPERS, TABLECLOTHS, CURTAINS, AND SIMILAR ITEMS.
- DO NOT PLACE SOURCES OF NAKED FLAMES, SUCH AS LIGHTED CANDLES, ON THE UNIT.
- DISPOSE OF BATTERIES IN AN ENVIRONMENTALLY FRIENDLY MANNER.

WARNING:

TO REDUCE THE RISK OF FIRE, ELECTRIC SHOCK OR PRODUCT DAMAGE, DO NOT EXPOSE THIS APPARATUS TO RAIN, MOISTURE, DRIPPING OR SPLASHING AND THAT NO OBJECTS FILLED WITH LIQUIDS, SUCH AS VASES, SHALL BE PLACED ON THE APPARATUS.

The socket outlet shall be installed near the equipment and easily accessible or the mains plug or an appliance coupler shall remain readily operable.

This product may receive radio interference caused by mobile telephones during use. If such interference is apparent, please increase separation between the product and the mobile telephone.

THIS UNIT IS INTENDED FOR USE IN MODERATE CLIMATES.

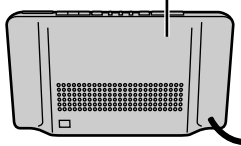

(Back of product)

CAUTION	INVISIBLE LASER RADIATION WHEN OPEN AND INTERLOCKS DEFEATED. AVOID EXPOSURE TO BEAM. (IEC60825-1Classe 3B)
ATTENTION	RAYONNEMENT LASER INVISIBLE DANGEREUX EN CAS D'OUVERTURE ET, LORSQUE LA SECURITE EST NEUTRALISEE, EXPOSITION DANGEREUSE AU FASCICUL.
ADVARSEL	USYNLIG LASERSTRÅLING VED ÅPNING, NÅR SIKKERHEDSÅBRYDNERE ER LØSE AF FUNKTION. UNDGÅ UDSÆTTELSE FOR STRÅLING.
VARO!	AVIATTAESSA, JA SUOJALUUNTUS OHITETTÄESSÄ OLET ALTUINA NÄKYMÄTÖNÄ LASERISÄTELYLLE, ÄLÄ KATSO SÄTEESEEN.
WARNING	OSYNLIG LASERSTRÅLING NÅR DENNA DEL ÄR ÖPPNAD OCH SPÄRREN ÄR URKOPPLAD. BETRÄKTA EJ STRÅLEN.
VORSICHT	UNSIICHTBARE LASERSTRÄHLUNG, WENN ABDECKUNG GEÖFFNET UND SICHERHEITSVERREGELUNG ÜBERBRÜCKT, NICHT DEM STRAHL AUSSETZEN.
ADVARSEL	USYNLIG LASERSTRÅLING NÅR DENDEL ÅPNES OG SIKKERHEDSLÅS BRYTES. UNNGÅ EKSPONERING FOR STRÅLEN. (IOLX50053)

(Inside of product)



(For United Kingdom) ("EB" area code model only)

For your safety, please read the following text carefully.

This appliance is supplied with a moulded three pin mains plug for your safety and convenience.

A 5-ampere fuse is fitted in this plug.

Should the fuse need to be replaced please ensure that the replacement fuse has a rating of 5-ampere and that it is approved by ASTA or BSI to BS1362.

Check for the ASTA mark  or the BSI mark  on the body of the fuse.

If the plug contains a removable fuse cover you must ensure that it is refitted when the fuse is replaced.

If you lose the fuse cover the plug must not be used until a replacement cover is obtained.

A replacement fuse cover can be purchased from your local dealer.

CAUTION!

IF THE FITTED MOULDED PLUG IS UNSUITABLE FOR THE SOCKET OUTLET IN YOUR HOME THEN THE FUSE SHOULD BE REMOVED AND THE PLUG CUT OFF AND DISPOSED OF SAFELY.
THERE IS A DANGER OF SEVERE ELECTRICAL SHOCK IF THE CUT OFF PLUG IS INSERTED INTO ANY 13-AMPERE SOCKET.

If a new plug is to be fitted please observe the wiring code as stated below. If in any doubt please consult a qualified electrician.

IMPORTANT

The wires in this mains lead are coloured in accordance with the following code:

Blue: Neutral, Brown: Live.

As these colours may not correspond with the coloured markings identifying the terminals in your plug, proceed as follows:

The wire which is coloured Blue must be connected to the terminal which is marked with the letter N or coloured Black or Blue.

The wire which is coloured Brown must be connected to the terminal which is marked with the letter L or coloured Brown or Red.

WARNING: DO NOT CONNECT EITHER WIRE TO THE EARTH TERMINAL WHICH IS MARKED WITH THE LETTER E, BY THE EARTH SYMBOL \perp OR COLOURED GREEN OR GREEN/YELLOW.

THIS PLUG IS NOT WATERPROOF—KEEP DRY.

Before use

Remove the connector cover.

How to replace the fuse

The location of the fuse differ according to the type of AC mains plug (figures A and B). Confirm the AC mains plug fitted and follow the instructions below. Illustrations may differ from actual AC mains plug.

1. Open the fuse cover with a screwdriver.

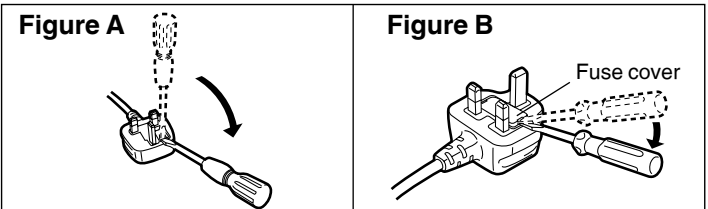

2. Replace the fuse and close or attach the fuse cover.

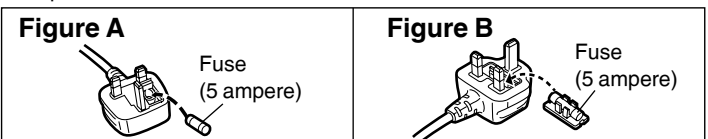

Precautions

- Avoid using or placing this unit near sources of heat.
- Avoid cuts, scratches, or poor connections in the AC mains lead, as they may result in possible fire or electric shock hazard. Also, excessive bending, pulling or splicing of the cord should be avoided.
- Do not unplug the AC mains lead by pulling on the cord. To do so may cause premature failure or a shock hazard.
- Do not operate this unit on AC power in a bathroom, as a potential shock hazard may result.

Cautions

Batteries

- **If the unit is not used for a long period of time, remove the batteries to prevent potential damage due to possible battery leakage.**
- Do not heat, disassemble, or allow contact with flame or water.
- Do not peel off the covering and do not use if the covering has been peeled off.

Battery mishandling can cause electrolyte leakage which can damage items the fluid contacts and may cause a fire.

If electrolyte leaks from the batteries, consult your dealer.

Wash thoroughly with water if electrolyte comes in contact with any part of your body.

CDs

- Do not use irregularly shaped CDs.
- Do not use non-specification discs.
- Do not use CDs printed with label printers available on the market.
- Do not use CDs with labels and stickers that are coming off or with adhesive exuding from under labels and stickers.

Note on CD-R/RW

This unit can play CD-R and CD-RW recorded with CD-DA. Use an audio recording disc and finalize* it when you finish recording. The unit may not be able to play some discs due to the condition of the recording.

* A process that enables CD-R/CD-RW players to play audio CD-R and CD-RW.

Specifications

Frequency range

FM: 87.5 to 108.0 MHz (50 kHz step)

AM: 522 to 1629 kHz (9 kHz step)

Sampling frequency 44.1 kHz

Decoding 16 bit linear

Beam source Semiconductor laser (wavelength 780 nm)

Number of channels 2 channel, stereo

Wow and flutter Less than possible measurement data

D/A converter 1 bit DAC

Speakers 4.5 cm, 6 Ω x 2

Power requirement AC 230-240 V, 50 Hz

Power consumption: 11 W

Memory back-up 9 V (One 6F22/6LR61, 006P battery)

Dimensions (W x H x D) 266 x 149 x 137 mm

Mass 1.47 kg without battery (**For the United Kingdom**)

1.43 kg without battery (**For Australia and New Zealand**)

Power consumption in standby mode: 2.3 W

Note

Specifications are subject to change without notice.

Mass and dimensions are approximate.

Maintenance

To clean this unit, wipe with a soft, dry cloth.

- Never use alcohol, paint thinner or benzine to clean this unit.
- Before using chemically treated cloth, read the instructions that came with the cloth carefully.

ONLY FOR AUSTRALIA/NEW ZEALAND

WARRANTY

1. The product is warranted for labour and parts for twelve (12) months from the date of purchase.
2. This Warranty is for normal domestic use only and excludes any defect or injury caused by or resulting from misuse, abuse, neglect, accidental damage, improper voltage, vermin infestation or any alteration which affects the reliability or performance of the unit, not attributable to faulty manufacture, parts and labour.
3. This warranty does not cover the following items unless fault or defect being complained of existed at the time of purchase.
 - (a) Video or Audio Tapes.
 - (b) Video or Audio Heads and Stylus resulting from wear and tear in normal use.
 - (c) Shaver Heads or Cutters.
 - (d) Cabinet parts.
 - (e) Batteries.
4. If warranty service is required you should :
 - Contact your nearest Panasonic Authorised Service Centre.
 - Enclose a copy of your purchase receipt as proof of date of purchase.
 - Send or bring the product to Panasonic Authorised Service Centre. Warranty does not include any freight to and from the user or insurance so please arrange this yourself.
 - Note that home service is available for following products in the Metropolitan area or the normal operating areas of the nearest Authorised Service Centres.
 - Television Receivers (screen size greater than 39 cm)
 - Electronic Organs or Pianos
 - Microwave Ovens
 - Washing Machines
 - Air Conditioners
5. The warranties hereby conferred do not extend to any costs associated with the delivery, handling, freighting or transportation of the product or any part thereof or replacement of and do not extend to any damage or loss occurring during, or associated with, transit.

Unless otherwise specified to the consumer the benefits conferred by this express warranty are additional to all other conditions, warranties, guarantees, rights and remedies expressed or implied by the Trade Practices Act 1974 and similar consumer protection provisions contained in legislation of the States and Territories and all other obligations and liabilities on the part of the manufacturer or supplier and nothing contained herein shall restrict or modify such rights, remedies, obligations or liabilities.

THIS WARRANTY CARD SHOULD BE RETAINED BY THE CUSTOMER AT ALL TIMES

IF YOU REQUIRE ASSISTANCE REGARDING WARRANTY CONDITIONS,
OR ANY OTHER ENQUIRIES, PLEASE TELEPHONE:

PANASONIC CUSTOMER CARE CENTRE 132 600

PANASONIC AUSTRALIA PTY. LIMITED OFFICE LOCATIONS:

NEW SOUTH WALES
P.O. Box. 505 Frenchs Forest N.S.W. 2086

VICTORIA
Private Mail Bag 13, South Eastern Mail Centre VIC. 3176

SOUTH AUSTRALIA
P.O. Box. 500 Welland 5007

WESTERN AUSTRALIA
P.O. Box. 376 Welshpool 6986

QUEENSLAND
P.O. Box. 260 Nundah QLD. 4012

Panasonic



Connect the antenna

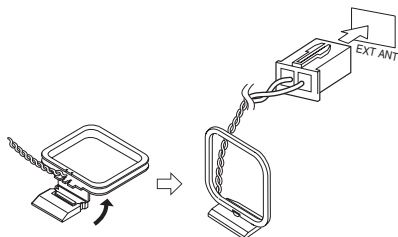

- Stand the antenna up so it clicks into place.
- When disconnecting, pull firmly.

Improving reception

- Extend and change the direction of the antenna.

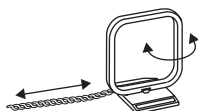

Note

These speakers do not have magnetic shielding. Do not place them near televisions, personal computers or other devices easily influenced by magnetism.

Connect the AC mains lead to household mains socket

(The United Kingdom only)
BE SURE TO READ THE CAUTION FOR THE AC MAINS LEAD ON PAGE 2 BEFORE CONNECTION.

Insert a battery (not included) for memory backup (bottom of unit)

- 1 Press down on the catch and pull down.

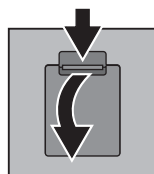

- 2 Pull out the connector and attach the battery.

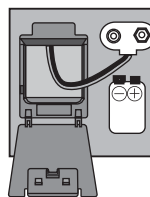

6F22/6LR61,
006P battery
(not included)

- 3 Insert the battery as shown.

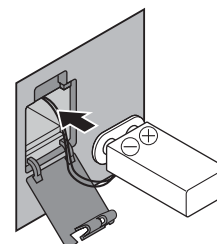

This battery saves the clock, alarm, and radio-preset settings if power is interrupted. It lasts about a year (one month without AC power).

Setting the clock

This is a 12-hour clock. This example shows how to set the clock for 3:30 P.M. Reset the clock regularly to maintain accuracy. (Monthly accuracy +/- 30 seconds.)

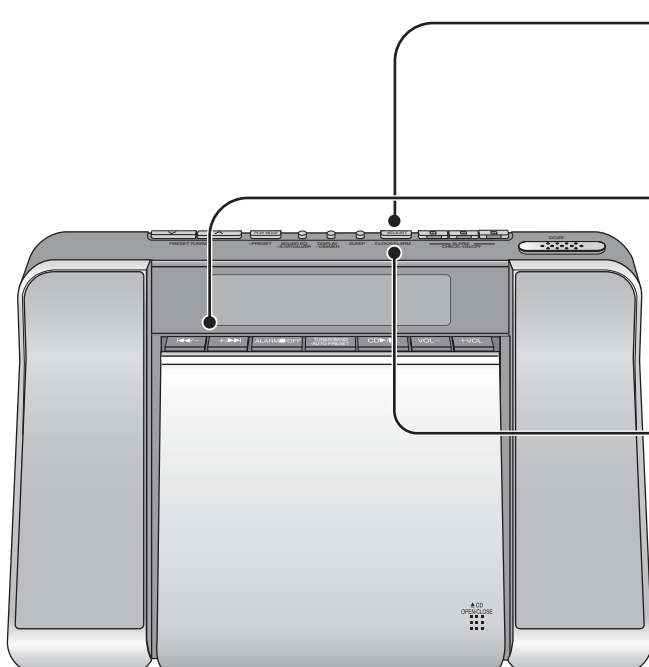

- 1 Press to select the time setting



Summer time setting (☀) → Time setting



- 2 Within 10 seconds, press to set the time

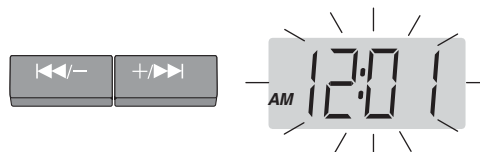

Press and hold to change the time faster.

- 3 Press to start the clock and finish

The display returns to its original state after a confirmation tone is heard.



Summer time

Do the following to advance the clock by an hour during the summer months.

- 1 Press [ADJUST, CLOCK/ALARM] to select the summer time setting (☀).
- 2 Press [◀◀/-] or [+/▶▶] to select "on".
- 3 Press [ADJUST, CLOCK/ALARM] to finish (a tone sounds).
☀ appears and the clock advances by an hour.

Repeat the above, selecting "OFF" in step 2, to turn ☀ off and restore the time.

Manual tuning

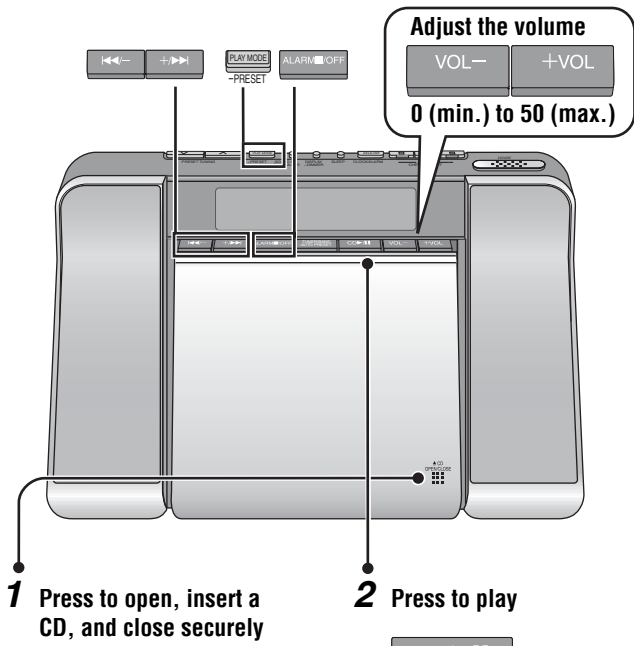

▲ CD OPEN/CLOSE



The unit turns off automatically after finishing play of the last track.

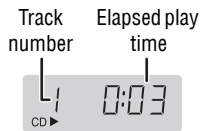

Insert label out so it clicks into place

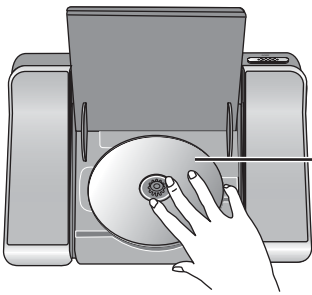

To prevent damage to the CD, stop the disc before opening the CD lid.

Pause	<p>Press</p> <p>Press again to restart play</p>
Stop and off	<p>Press</p> <p>Note When the CD is stopped the unit also turns off automatically. You cannot use skip, search, or the play mode. The unit is in the standby condition when the AC power supply cord is connected. The primary circuit is always "live" as long as the power cord is connected to an electrical outlet.</p>
Skip/Search	<p>Press to skip, press and hold to search</p> <p>Backward Forward</p>
Repeat/Random	<p>Press to select the mode</p> <p>1↻: Repeat one track ↻: Repeat all tracks RND: Play all tracks randomly No display: Play modes off</p>

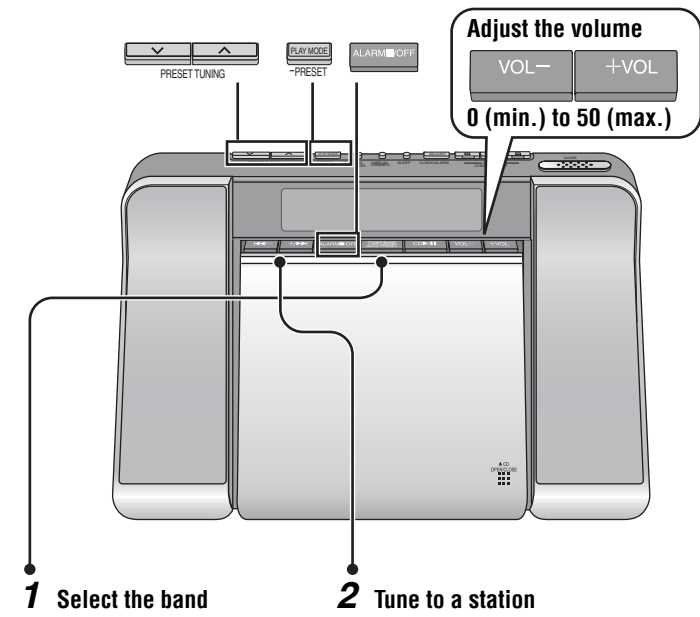

In step 2, press and hold to start automatic tuning. Tuning stops when a station is found.

Off	<p>Press</p>
FM mode	<p>Press</p> <p>Switch to MONO if there is a lot of noise in FM</p> <p> MONO</p> <p>Sound will not be stereo but noise should reduce. Press again to cancel.</p>

Preset tuning

Preset up to 20 FM and 12 AM stations. Use Auto Preset to preset all the stations the unit can receive, or Manual Preset to preset only those stations you want.

Auto Preset

Do the following once each for FM and AM.

Press and hold



The frequency returns to the lowest in the band, then it scrolls and "AUTO" flashes. The first station to be preset plays when finished.

Manual Preset

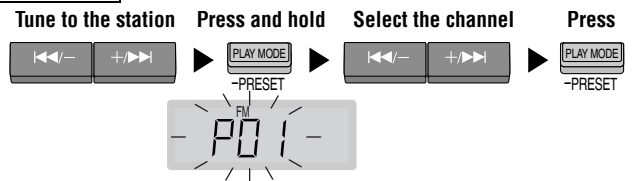

Selecting channels



Using the alarms

Set the unit to come on and play a CD or the radio with ALARM 1, or to sound a buzzer with ALARM 2 and ALARM 3.

Preparation: Set the time. For ALARM 1, play the CD track or radio station and set the unit to the volume you want to wake up to.

- 1 Press to select one of the alarm types you want to set (ALARM 1, 2, 3)**
 Press **ADJUST** (CLOCK/ALARM) → Summer time setting (☀) → Time setting → ALARM 1
 (Original display) ← ALARM 3 ← ALARM 2
- 2 Within 10 seconds, press to set the alarm time**
 Press and hold **◀** or **▶** to change the time faster.
- 3 Press to confirm**
 The display returns to its original state after a confirmation tone is heard.
- 4 Press and hold to turn the alarm on (the [DOZE] button lights)**
 When more than 2 alarm settings are turned on, only the alarm time that will occur first is displayed.

Buttons shown: ALARM/□/OFF, SOUND EQ -S.VIRTUALIZER, DISPLAY -DIMMER, SLEEP, DOZE.

The alarm sounds at the set time and stops automatically after an hour. ALARM 1 plays the CD track or radio station at the volume set (a buzzer sounds if you take out the CD). ALARM 2 and 3 sound buzzers (you cannot change the volume of the buzzer). You can still play a CD or the radio after setting an alarm.

Checking the settings	<p>Press</p> <p>ALARM -CHECK-ON/OFF</p>
To turn the alarm off	<p>Press and hold</p> <p>The settings stay the same. Press and hold again to turn on again (while playing the CD or radio for ALARM 1).</p>

Doze	<p>Press DOZE</p> <p>The alarm sounds again 6 minutes later.</p>
To shut off the alarm	<p>Press</p> <p>Settings stay the same and the alarm sounds again the next day.</p>

Other features

Sound quality

Sound Equalizer

Press



Bass: Emphasizes the bass



Clear: Clarifies the treble



Soft: For background music



Vocal: Adds gloss to vocals



Off

EQ appears while Sound EQ is on.

Sound Virtualizer

This stabilizes the midrange, such as vocals, and gives sound natural width and depth. Use it when listening to stereo sources. (Actual effect depends on the source.)

Press and hold



Press and hold again to cancel.

Sleep timer

Set the unit to switch off after a certain number of minutes.

Press



Each time you press the button:

30 → 60 → 90 → 120
 OFF ←

To check the remaining time, press once.

Display

The CD and radio displays disappear after a few seconds. To show them again:

Press



Dimmer

Press and hold



The display switches between bright and dim each time you do this.