

# diabLOTEK™

## DIAMOND ATX MID TOWER USER MANUAL



## ■ **Product Overview**

Features – – – – – P.2

Front I/O Pin Define – – – – – P.3

## ■ **Installation Guide**

Opening / Closing Chassis – – – – – P.5

Disassemble Chart – – – – – P.4

Installing Motherboard – – – – – P.6

Installing Add On Card – – – – – P.7

Installing 5.25" Device – – – – – P.8

Installing 3.5" Device – – – – – P.9

Installing HDD – – – – – P.10

■ **Warranty** – – – – – P.11-12

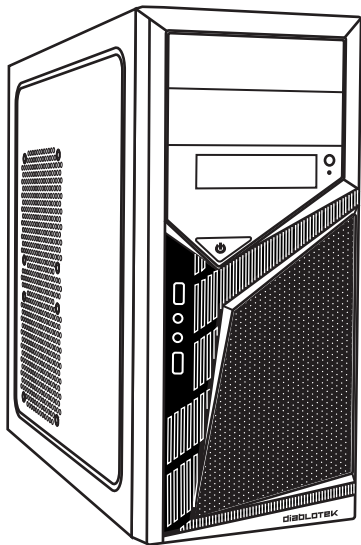

- SGCC CASE MATERIAL
- COMPATIBLE WITH MICRO ATX / ATX MOTHERBOARD
- 2 X INTERNAL 5.25" DRIVE BAYS
- 1 X EXTERNAL 3.5" DRIVE BAY
- 2 X INTERNAL 3.5" DRIVE BAYS
- 7 X EXPANSION SLOTS
- FRONT PANEL PORTS:  
2 X USB 2.0 PORTS  
AUDIO IN/OUT (AC97, HD)
- BUILD-IN POWER SUPPLY:  
1 X 400WATT ATX POWER SUPPLY
- OPTIONAL FAN EXPANSION:  
2 X FRONT 80/90/120 MM FAN  
2 X SIDE 80/90/120 MM FAN  
1 X REAR 80/90/120 MM FAN  
1 X BOTTOM 80/90/120 MM FAN
- CASE DIMENSIONS (WXHXD): 7.09" X 16.06" X 15"
- CASE WEIGHT: 9 Lbs

HD CONNECTOR	AC97 CONNECTOR
USB2.0 CONNECTOR	

PIC	ITEM	PURPOSE	PIC	ITEM	PURPOSE
	STANDOFFS x 9	Motherboard		SCREWS x 8	HDD
	SCREWS x13	Motherboard Power Supply		Buzzer x1 (PC Speaker)	Motherboard
	SCREWS x 8	ODD, Floopy			

# DISASSEMBLE CHART

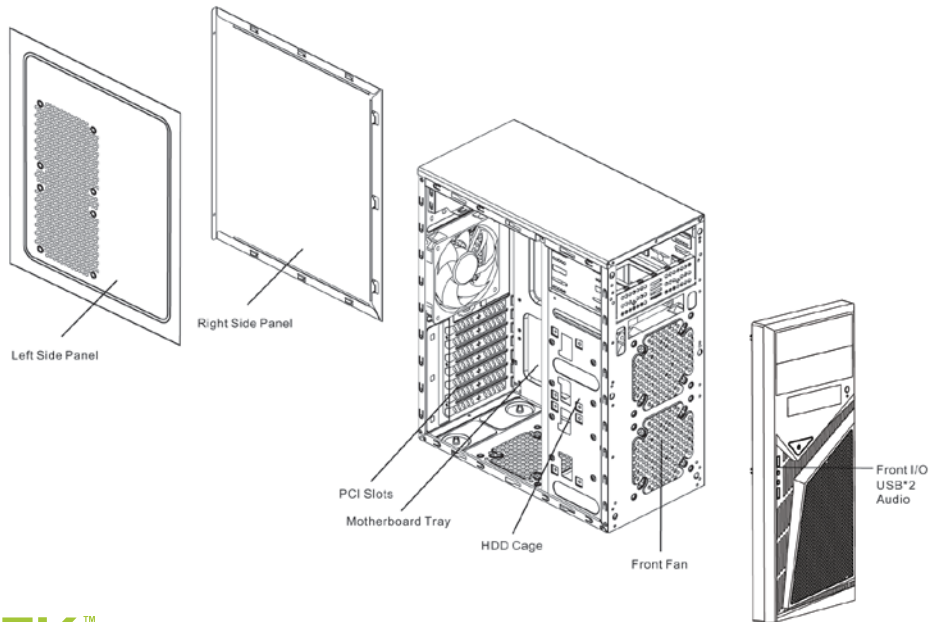

**diablotek**™

Thank you for purchasing Diablotek Product.  
Please register your product at [www.diablotek.com](http://www.diablotek.com) for complete warranty.

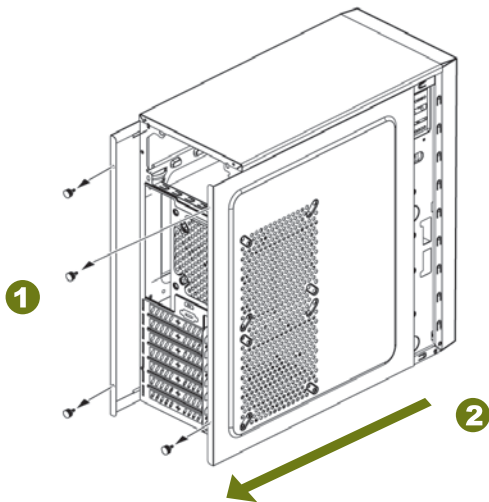

- Unscrew to remove left and right panel.

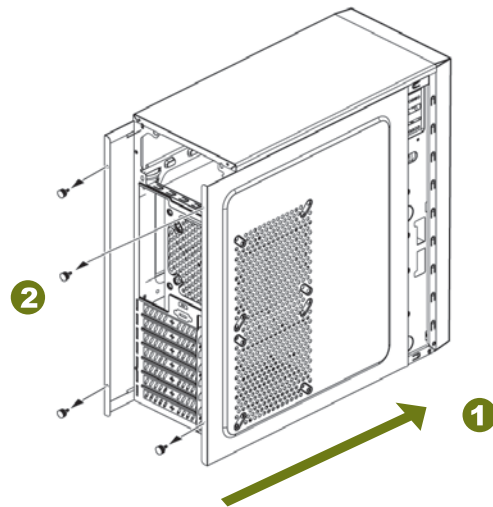

- Make sure all necessary cables and wires are connected, then reinstall side panels and secure with screws.

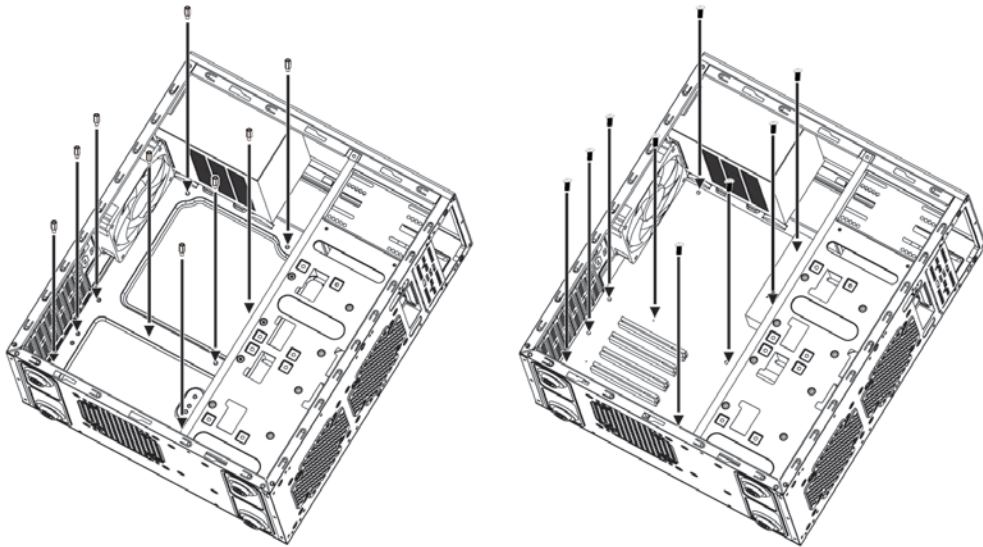

- Install motherboard standoffs according to your motherboard's screw holes.
- Place the motherboard onto standoffs and secure with screws.

## INSTALLING ADD ON CARD

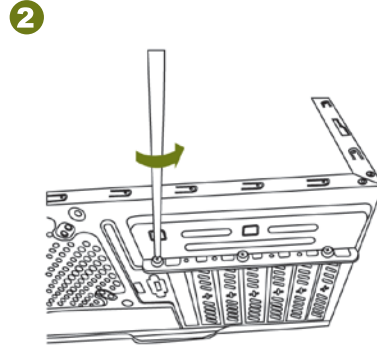
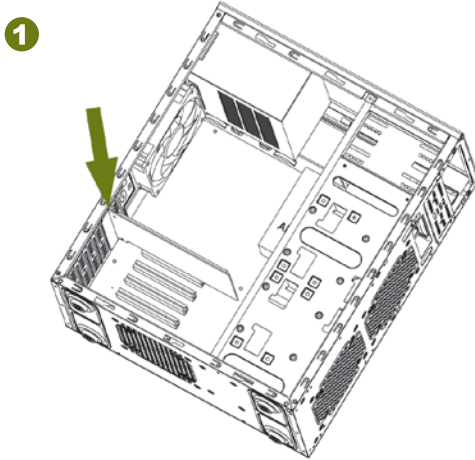

- Confirm which slot you want to install an add-on card then unscrew to remove the mesh cover.
- Install the add-on card and secure with screws.



## INSTALLING 5.25" DEVICE

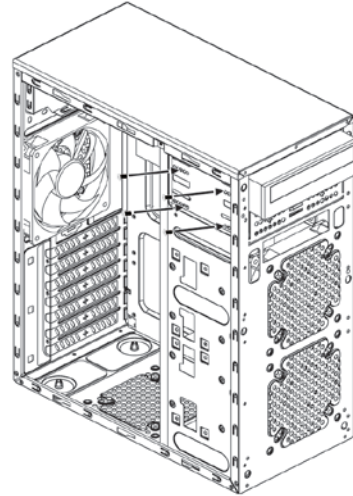
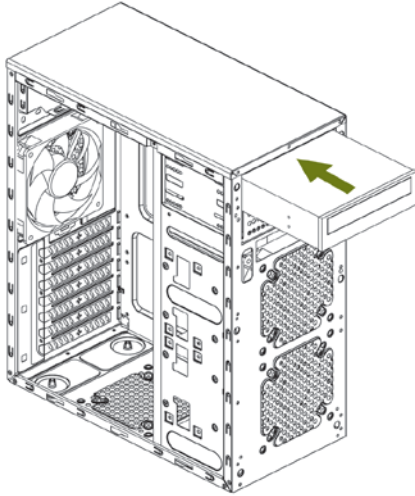

- Insert the 5.25" device from the front panel into the chassis then secure with screw.

## INSTALLING 3.5" DEVICE

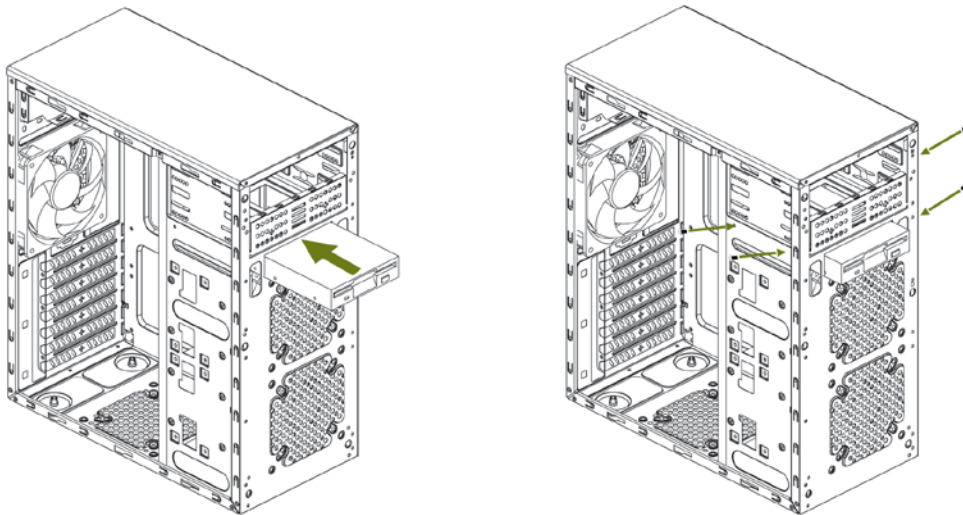

- Insert the external 3.5" device from the front panel into the chassis then secure with screws.

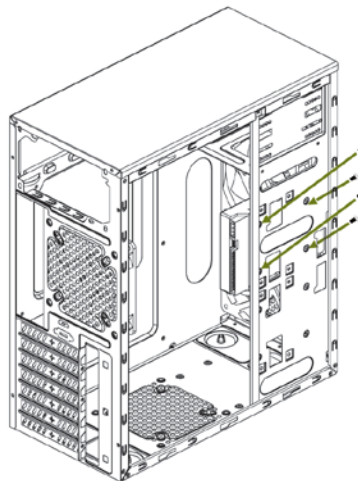
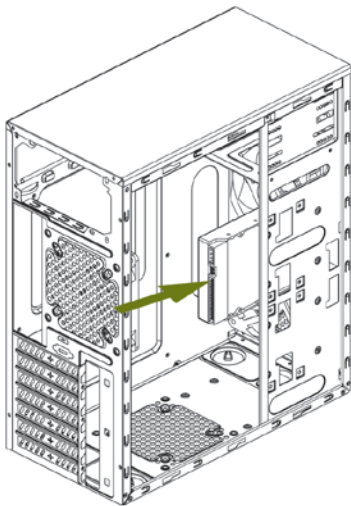

- Insert the HDD into its slot as illustrated above.
- Push to the bottom to secure with screws.

## 1 YEAR WARRANTY

DIABLOTEK warrants the "DIAMOND ATX MID TOWER" (Model No.: CPA-0170) with 1 Year warranty to be free from defects in materials and workmanship for the product. This warranty is for replacement only. This warranty does not cover item out of production if the company no longer stocks them. (1 year is defined as 1 year of the product on the market. Outdated technology is not covered by 1 year warranty if the item is no longer available on the common market as a new product.) This warranty is not assignable. Third party products, such as motherboards and other system components using or interacting with the DIABLOTEK products are not covered by this warranty.

DIABLOTEK's sole obligation under this warranty is to replace or, at its option, to repair, free of charge, all the product's defective parts. This warranty applies only on the condition that the product has been installed, maintained, and operated under conditions of normal use and in accordance with the installation guide provided herewith. The provisions of this warranty shall not apply if, in DIABLOTEK's sole judgment, the product has been subject to misuse or neglect, improper installation, damaged in an accident, or repaired or altered in any way that affects its performance or reliability.

Warranty coverage on DIABLOTEK "DIAMOND ATX MID TOWER" shall be VOID under the following conditions:

1. The "DIAMOND ATX MID TOWER" shows evidence of the serial/part number sticker(s) being altered, removed, replaced, or defaced.
2. The "DIAMOND ATX MID TOWER" had been damaged while being opened.
3. The "DIAMOND ATX MID TOWER" had been damaged by hardware from a company or individual other than DIABLOTEK or by motherboard incompatibility.
4. The "DIAMOND ATX MID TOWER" had not been operated in accordance with DIABLOTEK specifications, instructions, or any technical support directions.
5. The "DIAMOND ATX MID TOWER" had been modified or damaged by user error, accident, disaster, abuse, misuse, alteration, repair, modification, a fix/replacement by a company or individual other than DIABLOTEK.

To obtain warranty services during the warranty period, contact DIABLOTEK at **(626) 771-3230** or visit DIABLOTEK at **[www.diablotek.com](http://www.diablotek.com)**.



**diabLOTEK**<sup>™</sup>  
[www.diablotek.com](http://www.diablotek.com)