

HP Officejet 7500A Wide-Format e-All-in-One

Print Fax Scan Copy Web



A3 ALL-IN-ONE VERSATILITY¹. WIRELESS PRODUCTIVITY².



¹ Prints up to A3+. Copy and scan up to A3-size with ArcSoft® Scan-n-Stitch™ Deluxe software. Fax function limited to A4 only.

² Wireless performance depends upon physical environment and distance from access point.



Print professional colour documents for the lowest cost per page compared with in-class, wide-format inkjet all-in-ones¹. This versatile all-in-one with wireless networking² lets you print from 3 x 5 to 13 x 19 inches (A3+). And with HP ePrint, you can now print from anywhere, anytime with any mobile device³.

A3 ALL-IN-ONE VERSATILITY

- Produce borderless marketing materials⁴ and documents in a wide range of sizes—from 3 x 5 to 13 x 19 inches (A3+)—and easily fax, scan and copy.
- Increase your productivity with a 150-page wide-format tray and a 35-page automatic document feeder that handles a variety of paper types and sizes.
- Copy and scan up to A3-size with ArcSoft® Scan-n-Stitch™ Deluxe software.
- Fax at speeds up to 33.6 Kbps and cut down on wasted resources by blocking out incoming junk faxes with Junk Fax Blocker⁵.
- With Digital Fax and Scan solutions, you can store and archive faxed documents to your PC, and save scanned materials to a PC, network folder or e-mail⁶.

Multiple paper sizes up to A3+



Digital Fax & Scan solutions



HIGH PERFORMANCE PRINT SPEEDS

- Print at up to 33 pages per minute (ppm) black, 32 ppm colour⁷ and at laser-comparable (ISO) speeds up to 10 ppm black, 7 ppm colour⁸.

STUNNING PRINTS, LOWEST COST-PER-PAGE

- Print professional-quality colour documents for the lowest cost per page, compared with in-class, wide-format inkjet all-in-ones¹.
- Economical individual ink cartridges let you replace each cartridge separately, and optional high-capacity cartridges⁹ offer even greater value for frequent printing.
- Produce stunning marketing materials in-house and save money without having to outsource.
- With HP Officejet inks, you'll get fade-resistant prints with professional colour graphics, stunning photos and laser-quality black text¹⁰. HP recommends ColorLok® papers¹¹ for best printing results.

Maximum speeds up to
33 ppm black⁷ | **32** ppm colour⁷

Laser-comparable (ISO)
 speeds up to

10 ppm black⁸ | **7** ppm colour⁸



¹ Letter/A4 cost per page comparisons for B-size inkjet all-in-ones with fax <US\$300 from major vendors as of March 2010. For details, see www.hp.com/go/officejet. ² OJ ISO yield with highest-capacity cartridges based on continuous printing. For details, see www.hp.com/go/learnaboutsupplies. ³ Wireless performance depends upon physical environment and distance from access point. ⁴ May require an Internet connection to the printer. Feature works with any Internet- and e-mail-capable device. For details, www.hp.com/go/ePrintCenter. ⁵ On brochure and photo paper only. ⁶ Requires caller ID service, not included. Price and service are subject to contract.

⁶ Visit www.hp.com/support to download the latest software. ⁷ After first page; for more information, see www.hp.com/go/inkjetprinter. ⁸ Based on ppm measured using ISO/IEC 24734. Standard applies to inkjet and laser products and excludes first set of test documents. For details, see www.hp.com/go/inkjetprinter. ⁹ Not included. Please purchase separately. ¹⁰ Based on paper-industry predictions for acid-free papers and Original HP inks; colorant stability data at room temperature based on similar systems tested per ISO 11798 and ISO 18909. ¹¹ Based on HP internal testing using a range of plain papers, including papers with the ColorLok® logo. For details, go to www.hp.com/go/printpermanence.

OFFICE PRODUCTIVITY

- Use the intuitive 2.36-inch (5.99 cm) touchscreen colour graphics display to print, send faxes, make copies and scans. What's more, with print apps, you can print web content without using a PC¹.
- Share your all-in-one with a small workgroup with wireless networking², built-in Ethernet, or through the integrated Hi-speed USB 2.0 port.
- Easily view and print from a USB drive and memory cards.
- Simply copy a two-sided identification card onto one side of a page using the ID copy feature.

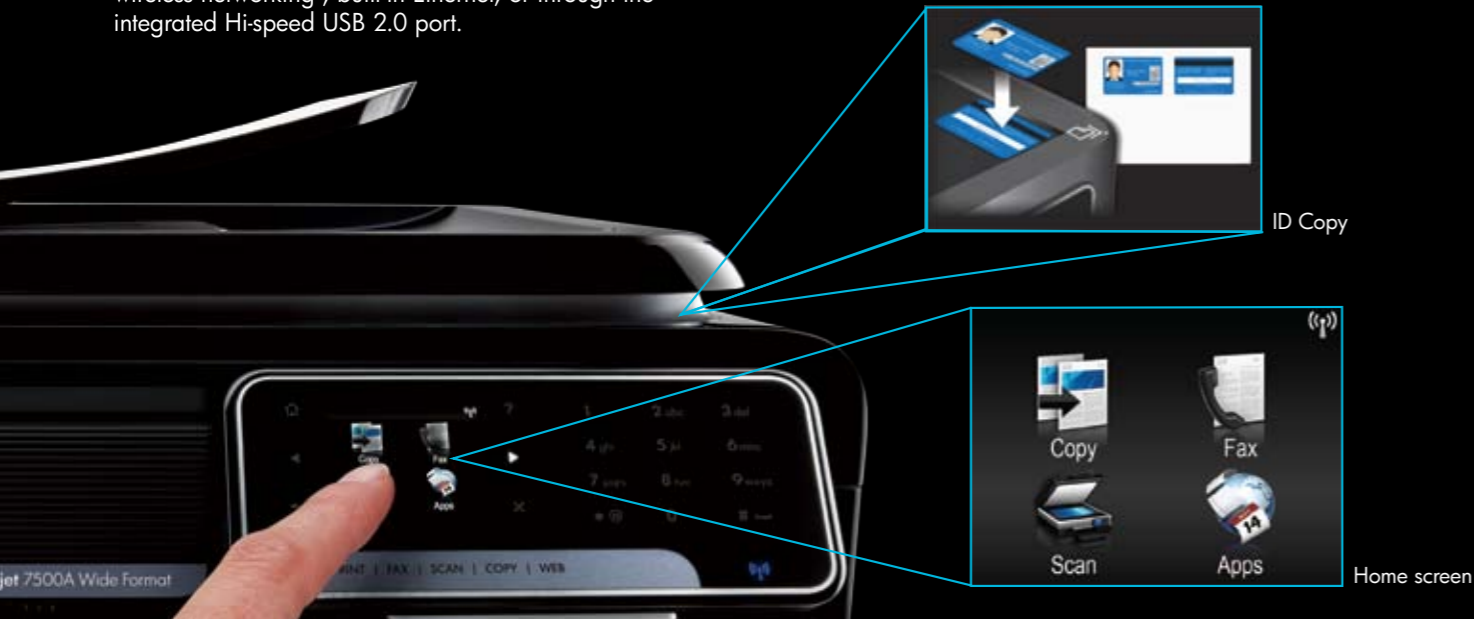

¹ Requires a wireless access point and an Internet connection to the printer. Services may require registration. Apps availability varies by country and language. For details, visit www.hp.com/go/ePrintCenter. ² Wireless performance depends upon physical environment and distance from access point. ³ May require an Internet connection to the printer. Feature works with any Internet- and e-mail-capable device. For details, www.hp.com/go/ePrintCenter.

PRINT INNOVATIONS FOR YOUR BUSINESS

Print from anywhere, anytime with HP ePrint.

- Print important emails, images or documents on the go using any email capable device³.
- Simply attach your photos or documents to the email address assigned to your e-All-in-One to have them printed. No software setup required.
- Send print jobs from a variety of email-capable devices like Apple iPad/iPhones, smartphones, desktops, laptops or netbooks³.
- HP ePrint provides industry-standard spam filtering to reduce the threat of harmful contents. Furthermore, a "protected" mode limits access of your web-connected printer to trusted users.

HP ePrint



Visit www.hp.com/go/ePrintCenter

SAVE ENERGY AND CONSERVE RESOURCES

- This ENERGY STAR[®] qualified all-in-one uses up to 40% less energy than comparable laser products⁴.
- Get free and easy recycling through HP Planet Partners. HP never refills, resells or sends ink cartridges to a landfill⁵.

ecoHIGHLIGHTS

HP Officejet Pro 7500A Wide-Format eAIO

- Use up to 40% less energy than with colour lasers⁴
- Prints great on recycled paper
- Save paper by viewing and storing faxes electronically



ENERGY STAR ENERGY STAR[®] qualified

www.hp.com/go/ecosolutions

Please recycle your computing hardware and printing supplies. Find out how at our website.



⁴ Most industry leading letter/A4-size colour laser all-in-ones <US\$600 as of March 2010; for details, see www.hp.com/go/officejet. Energy use based on HP testing using the ENERGY STAR[®] program's TEC test method criteria. ⁵ Program availability varies. HP print cartridge return and recycling is currently available in more than 49 countries, territories and regions in Asia, Europe, and North and South America through the HP Planet Partners program. For more information, visit www.hp.com/recycle.

HP Officejet 7500A Wide-Format e-All-in-One



CHOOSE HP PAPERS FOR OPTIMAL PRINTING RESULTS

HP Professional Paper, 120 (Matt)

Ideal for presentations, proposals, reports and newsletters

- Vibrant colours and graphics
- Coated on both sides for two-sided printing
- Heavier and more opaque

HP Papers with ColorLok Technology¹

Ideal for professional quality printing

- Prints dry faster with less smearing
- Darker black for bolder text and richer, deeper greys
- Uniform, vivid and vibrant colour



WHY BUY ORIGINAL HP PRINT CARTRIDGES

Exceptional value

Original HP print cartridges produce twice as many printed pages as compared to remanufactured and refilled ink cartridges².

Exceptional reliability

In a recent study, 42% of tested refilled cartridges were found dead on arrival or failed prematurely². With Original HP print cartridges, you can expect consistent, reliable and flawless performance.

Exceptional quality

Over 20 years of research and development have gone into the design of Original HP print cartridges to ensure that you get impressive and consistent print and photo quality every time.

Environmental commitment

HP's Planet Partners Program ensures that Original HP print cartridges collected are recycled responsibly. All cartridges returned to the program go through a multi-phase recycling process, and various parts are reduced to raw materials that are used to make new metal and plastic products.

Cartridge compatibility

STANDARD

For everyday printing that is precise and affordable



VALUE

For high volume printing, choose high capacity XL packs³



HP Order-a-Cartridge

Dial the toll free number for HP's Order-a-Cartridge⁴ service or order online at www.hp.com/apac/oac to have your HP print cartridges conveniently delivered to your doorstep.

China	800 820 0851 / 400 820 0851
Hong Kong	800 938 833
India	1800 425 4999 / 3030 4499
Indonesia	0800 1111 2222
Korea	080 703 0700
Malaysia	1800 88 9886
Philippines	1800 1441 6688
Singapore	1800 278 8863
Taiwan	0800 236 686
Thailand	02 353 9000
Vietnam	08 3920 5564

HP TOTAL CARE



At HP, great technology comes with HP Total Care.

HP's broad portfolio of services, solutions and customer support provides expert help at every stage of your HP product experience.

Discover how HP Total Care help you make IT hassle-free, visit www.hp.com/apac/totalcare

For instant access to HP customer support online, visit www.hp.com/support

HEWLETT-PACKARD OFFICES

Australia	13 23 47
China	800 820 2255
Hong Kong	800 93 8833
India	3030 4499 / 1800 425 4999
Indonesia	0800 1111 222
Korea	080 703 0700
Malaysia	1800 88 9886
New Zealand	0800 733 547
Philippines	1800 1441 6688
Singapore	1800 278 0182
Taiwan	0800 236 686
Thailand	(66-2) 353 9000
Vietnam	(84-8) 3920 5564

For the following countries, please fax your queries to: (65) 6275 6707

- Bangladesh • Bhutan • Brunei • Cambodia
- Maldives • Nepal • Pakistan • Sri Lanka

For more information, please visit us at www.hp.com/apac/homeandoffice

¹ HP recommends ColorLok papers for best printing results. ² Results of 3rd party testing, commissioned by HP done by TÜV SÜD PSB Ltd – 2010 Reliability Comparison Study Asia. Ink cartridges tested 45, 78, 56, 57, 60 Black & 60 Tri-colour. Full report available at www.tuv-sud-psb.sg/reportdisclaimer.aspx. Applicable for selected Original HP ink cartridges only. ³ High-capacity HP ink cartridges not included; please purchase separately. ⁴ Available in selected countries only.

* Wireless performance is dependant upon physical environment and distance from access point.
** May require an Internet connection to the printer. Feature works with any Internet- and e-mail-capable device. For details, www.hp.com/go/ePrintCenter.

HP Officejet 7500A Wide Format e-All-in-One

PRINT	<p>Technology Duty cycle (monthly) Resolution</p> <p>Printer Language</p>	<p>HP Thermal Inkjet Up to 7,000 pages Black: Up to 1200 optimised dpi from 600 input dpi Colour: Up to 4800 by 1200 optimised dpi colour (when printing from a computer on selected HP photo papers and 1200 input dpi) HP PCL 3 GUI</p>
PRINT SPEED¹	<p>Black-and-white Colour</p>	<p>Up to 33 ppm (maximum); Up to 10 ppm (laser-comparable/ISO speed²) Up to 32 ppm (maximum); Up to 7 ppm (laser-comparable/ISO speed²)</p>
FAX	<p>Speed³ Resolution Memory³ Speed dials Fax features</p>	<p>Up to 33.6 kbps, 3 seconds per page Black-and-white—Up to 300 x 300 dpi; Colour—Up to 200 x 200 dpi Up to 100 pages Up to 110 numbers Colour fax; auto reduction; auto redial; speed dial; group speed dial; junk barrier; poll to receive; forwarding (black only); distinctive ring; delayed send (black only); scan and fax; fax phone TAM interface; PC fax send and receive</p>
SCAN	<p>Type Resolution Maximum scanning size Input modes</p>	<p>Flatbed with Automatic Document Feeder (ADF) Optical: Up to 4800 dpi; Enhanced: Up to 19,200 dpi⁴; 48-bit colour bit depth, 256 greyscale levels 216 x 356 mm (8.5 x 14 inches) SW driver (Win/Mac OS), front panel, TWAIN, WIA based utility</p>
COPY	<p>Resolution Copy speed¹ Reduce/enlarge Maximum copies Copier settings</p>	<p>Black-and-white/colour—Up to 1200 x 600 dpi Black-and-white: Up to 33 cpm (draft); Colour: Up to 32 cpm (draft) 25–400% Up to 100 copies A: Media size include Legal, A3 and Ledger; B: B-size Stitch option</p>
DISPLAY		<p>2.36 inches (5.99 cm) touchscreen TFT LCD</p>
MEDIA HANDLING	<p>Automatic Document Feeder Paper capacity Duplex print</p>	<p>Up to 35 sheets Input capacity: Up to 150 sheets; Output capacity: Up to 100 sheets Manual</p>
MEDIA	<p>Custom sizes⁵ Standard sizes</p> <p>Weights Types</p>	<p>76 x 127 mm (3 x 5 inches) to 330 x 1118 mm (13 x 44 inches) A5, B5, executive, A4, letter, legal, tabloid, Hagaki, B7, 4 x 6 inches, 10 x 15 cm, HV, A6, 2L cabinet, 13 x 18 cm, 5 x 7 inches, Ofuku Hagaki, 8 x 10 inches, B4, 11 x 14 inches, A3, 12 x 12 inches, A3, Super B, A3+ 60 to 105 g/m² (plain media); 75 to 90 g/m² (envelope); up to 200 g/m² (cards); up to 280 g/m² (photo and brochure) Paper (plain, inkjet, photo), envelopes; brochure paper, transparencies, labels, cards (index, greeting)</p>
MEMORY		<p>128 MB RAM</p>
OPERATING SYSTEM COMPATIBILITY		<p>Microsoft® Windows® 7, Windows Vista®, Windows XP® (SP2), Mac OS X v 10.5, v 10.6, Linux (For more information, see http://hplipopensource.com/hplip-web/index.html)</p>
NETWORKING/CONNECTIVITY		<p>1 USB (2.0); 1 Ethernet; 1 Wireless 802.11b/g/n; 2 memory card⁶ slots; 1 RJ-11 fax</p>
SOFTWARE INCLUDED		<p>ArcSoft® Scann-Soft™ Deluxe v 1.1.1.36</p>
DIMENSIONS (W X D X H)		<p>606 x 426 x 293 mm (23.86 x 16.77 x 11.54 inches)</p>
WEIGHT		<p>14 kg</p>
OPERATING ENVIRONMENT		<p>Recommended: 15–32° C, 20–80% RH; Maximum: 5–40° C, 10–90% RH; Storage temperature: -40–60° C (+/- 10%), 50/60 Hz</p>
POWER SPECIFICATIONS⁷		<p>Power consumption—Active: 13 watts (printing); Powersave: 6 watts (standby); Input voltage — 100 to 240 VAC</p>

ORDERING INFORMATION

Number	Description
C9309A	HP Officejet 7500A Wide-Format e-All-in-One

SUPPLIES

CD971AA	HP 920 Black Officejet Ink Cartridge
CD972AA	HP 920XL Cyan Officejet Ink Cartridge
CD973AA	HP 920XL Magenta Officejet Ink Cartridge
CD974AA	HP 920XL Yellow Officejet Ink Cartridge
CD975AA	HP 920XL Black Officejet Ink Cartridge



ENERGY STAR and the ENERGY STAR mark are U.S. registered marks. Microsoft, Windows, and Windows XP are U.S. registered trademarks of Microsoft Corporation. Windows Vista is either a registered trademark or trademark of Microsoft Corporation in the United States and/or other countries.

© 2010 Hewlett-Packard Development Company, L.P.

The information contained herein is subject to change without notice. The only warranties for HP products and services are set forth in the express warranty statements accompanying such products and services. Nothing herein should be construed as constituting an additional warranty. HP shall not be liable for technical or editorial errors or omissions contained herein.

Printed in Singapore, July 2010.

- Print and copy speed may vary depending on the type of output.
- Based on ppm measured using ISO/IEC 24734. Standard applies to inkjet and laser products and excludes first set of test documents. For details, see www.hp.com/go/inkjetprinter.
- Based on standard ITU-T test image #1 at standard resolution. More complicated pages or higher resolution will take longer and use more memory.
- Maximum resolution is limited by available computer memory, disk space, and other system factors.
- Windows does not support custom paper sizes.
- Secure Digital, MultimediaCard, Secure MultimediaCard, Reduced-Size MultimediaCard (RS-MMC)/MMCmobile (adapter not included, purchase separately), MMCmicro/minisD/microSD (adapter not included, purchase separately), xD-Picture Card.
- Power measurements are based on ENERGY STAR® OM test procedure.