



Leading
the way in
Megapixel
video

H.264 Day/Night SurroundVideo® Installation Manual

 **Arecont Vision**
megapixel technology...
beyond imagination

H.264 Day/Night SurroundVideo® Installation Manual

Inside the box:

- A. Arecont Vision SurroundVideo® camera
- B. Mounting template
- C. RJ45 female to female coupler
- D. Hex key
- E. Security L-key
- F. Pack of four (4) wood screws and four (4) dry wall anchors

Not included but needed:

- #1 Phillips head screwdriver
- #2 Phillips head screwdriver
- Flat head screwdriver (for side conduit opening)

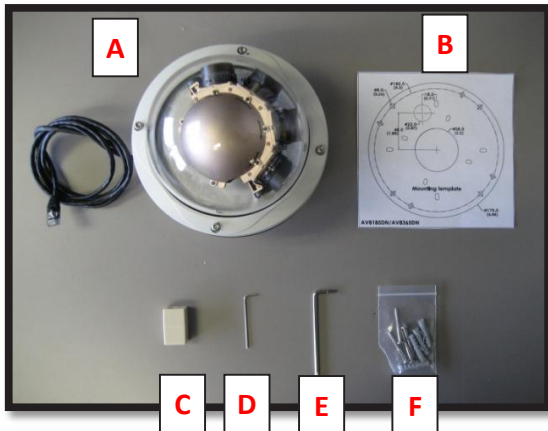

Image 1

Mounting the Camera:

1. Remove camera and hardware from the box.
2. Using the mounting template, prepare the mounting provisions for camera installation.

NOTE: Since SurroundVideo® series ship with both surface mount and in-ceiling mount, the mounting template takes both into consideration.

3. Using security L-key, loosen the four (4) screws securing the dome cover (**Image 2**). Remove vandal resistant dome cover.

NOTE: Do not remove screws from the dome cover.

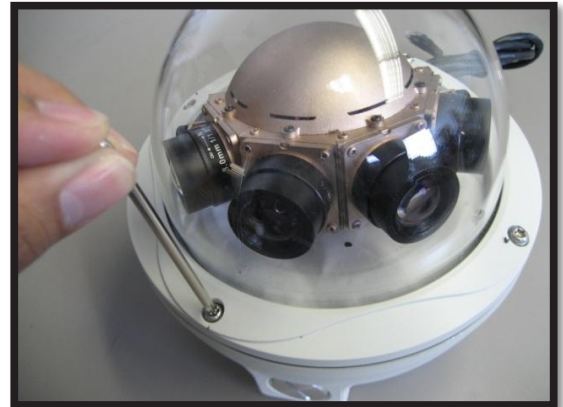

Image 2

4. If using in-ceiling mount, please use #2 Phillips head screwdriver to loosen the four (4) machine screws (**Image 3**) and remove in-ceiling mount housing from surface mount housing. (**Image 4**)

*NOTE 1: The above removed screws are also used to attach the camera with in-ceiling mount housing to the pendant mount (**Image 5**) and wall mount (**Image 6**). Do not disregard.*

NOTE 2: The in-ceiling mount only can be attached on hard ceilings including wood, plastic, metal and concrete.

NOTE 3: For use in a false ceiling, a flush mount adapter kit must be used.

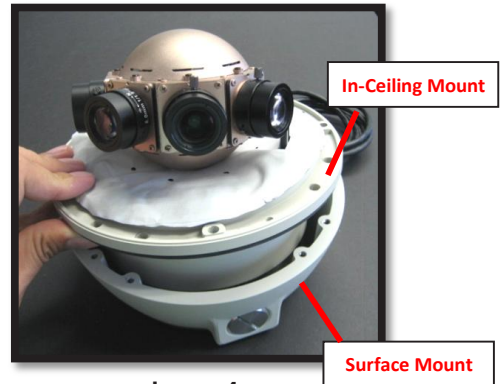

Image 4

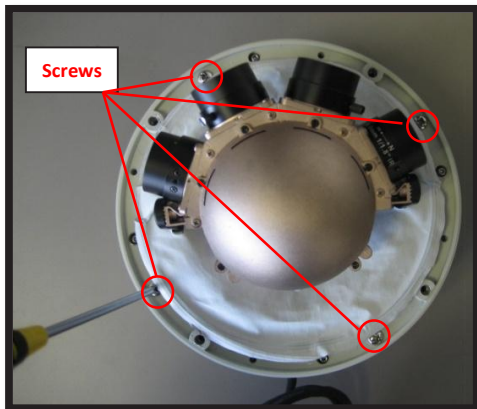

Image 3

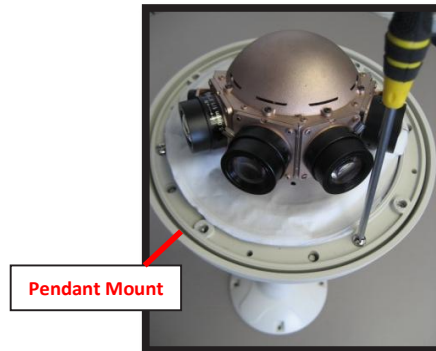

Image 5

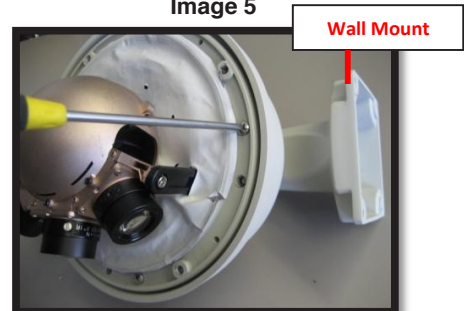

Image 6

5. If you are using the side conduit opening on the surface mount, remove the conduit plug by first removing the socket set screw using the provided Allen key (**Image 7**) and remove the conduit plug using a flat screwdriver.

Note: the conduit fits ¾" NPT standard

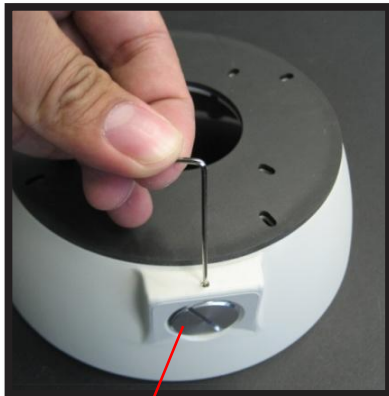

Image 7

Conduit Plug

Connecting External Power: (Optional)

6. If the camera is powered by an outside power supply, 12~20VDC or 24VAC, connect the power cable shown in **Image 8**.

Red	+
Black	-

Table 1

NOTE: Make sure that your installation of wires complies with Electrical Code of the local government where the camera is installed and no bare wires are exposed.

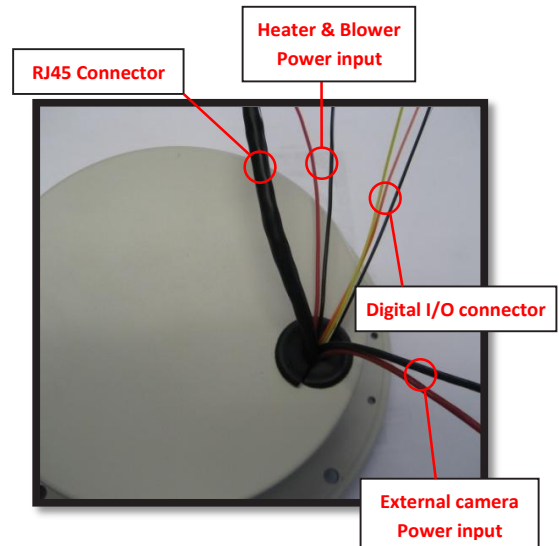

Image 8

Arecont Vision H.264 Day/Night SurroundVideo® Series Installation Manual

Connecting Digital I/O: (Optional)

- To use digital I/O, connect the I/O cable shown in **image 8**.

Electrical Characteristics:

		Min	Max
Input voltage (V) (measured between + and – terminals)	ON	2.9	6.3
	OFF	0	1.3
Output current (mA) (measured between + and – terminals)	ON	-	50
	OFF	-	0.1
Applied Voltage Range: 0 - 80V			

Table 2

NOTE: Both the input and the output are electrically isolated from the rest of the camera's electrical circuitry via general-purpose photo couplers. The input is additionally protected with a serial 250 Ohm resistor, and a debouncing circuit. Duration of any input signal should be at least 5 ms to comply with the requirements of the debouncing circuit.

Orange	OUT +
Yellow	OUT –
White	IN +
Black	IN -

Table 3

	On	Off
Heater	17C° (62.6 °F)	30 °C (86 °F)
Blower	10C° (50°F)	15 °C (59 °F)
Blower	50C° (122 °F)	45 °C (113°F)

Table 6

Connecting Heater and Blower : (AV8185DN-HB and AV8365DN-HB only)

- To run the heater and blower shown in **Image 8**, connect heater & blower power input to 12V to 20V DC or 24VAC power supply. (**Image 9**).

Power input	Power consumption
DC12V to 20V	11 Watts
AV24V	13 Watts

Table 4

Red	+
Black	-

Table 5

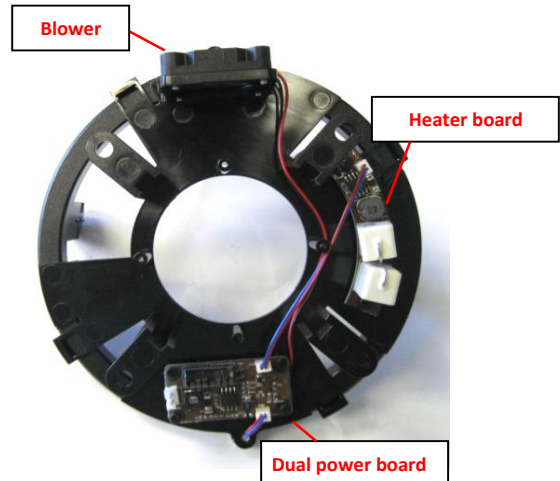

Image 9

- Align the holes in the camera with the prepared holes on the mounting surface. Attach the camera with in-ceiling mount housing to the surface mounting housing shown in **Image 4**.
- To insert camera with in-ceiling mount into hard ceiling with the wood screws or any optional hardware suitable for the mounting surface shown in **Image 10**

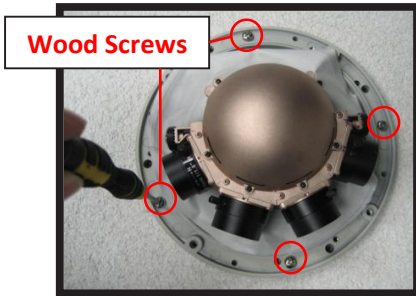

Image 10

Note: Use Flush Mount Adapter for false ceiling tile installation. (Image 11) Please refer to Flush Mount Adapter Installation Instructions on page 10.



Image 11

Adjusting Tilt, Pan and Focus:

- Power on camera to adjust tilt, pan and focus.
- To adjust the pan, use a #2 Phillips screwdriver to loosen both screws on the sides of the plastic gimbal bracket as shown in **Image 12** and **Image 13**.
- Adjust the pan as required and tighten the screw from **step 11** shown in **image 14**.

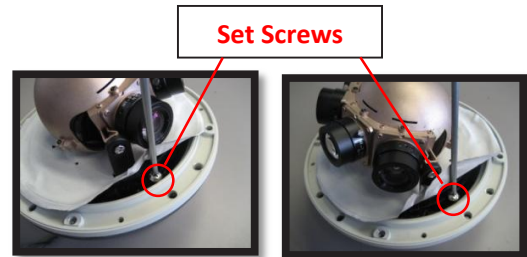

Image 12

Image 13



Image 14

- To adjust the tilt, use a #2 Phillips screwdriver to loosen both screws on the sides of the plastic gimbal bracket 1/4 turn (**Image 15 and 16**). **CAUTION: Do not remove the screws!**
- Adjust lens tilt as required and tighten the screws from **step 13** shown in **image 17**.

NOTE: the camera has 2-Axis gimbal with 360° pan and 100° tilt for easy and accurate positioning.

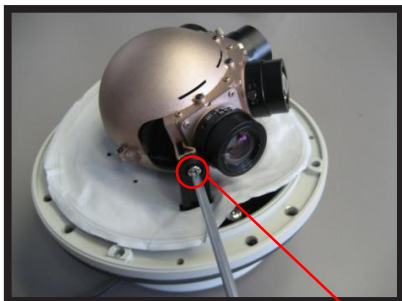

Image 15

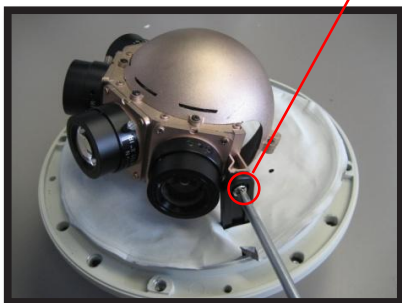

Image 16

Set Screws

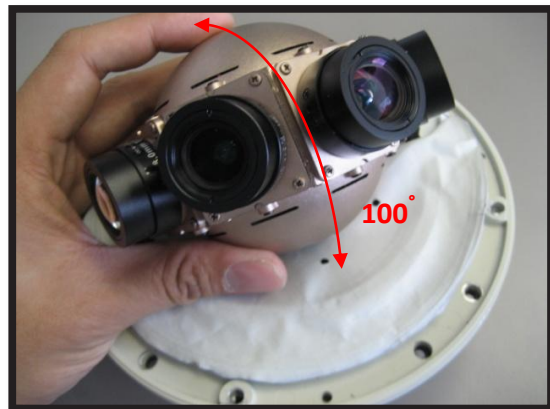

Image 17

- To adjust focus, loosen set screw on each lens as shown in **Image 18**.
- Adjust lens focus as required and tighten the screws from **step 15**.

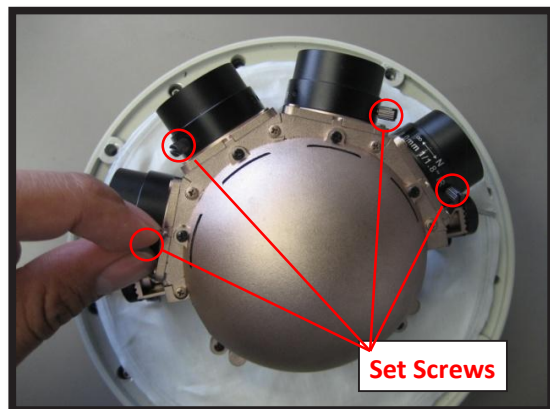

Image 18

Set Screws

Adjusting Each Sensor Tilt : (AV8365DN only)

NOTE: Each sensor tilt angle can be adjusted by +/- 10° to remove the dead spot at dome bottom or at the horizon.

15. To adjust each sensor tilt angle, use a #1 Philips screwdriver to turn set screws, shown in **Image 19** and **Image 20**.

16. Remove the protective film from the camera dome.

NOTE: be careful not to scratch the vandal dome cover.

17. Secure the vandal dome cover to the camera.

*NOTE 1: Day/Night switcher per sensor in both AV8185DN and AV8365DN shown in **Image 19**.*

NOTE 2: All Day/Night switchers simultaneous switchover, based on the least (or greatest) illuminated sensor.

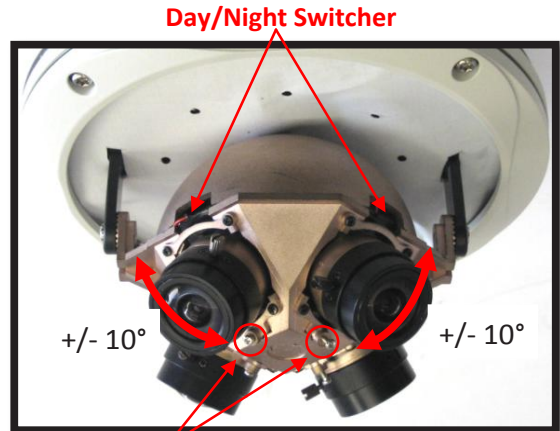

Set Screws

Image 19

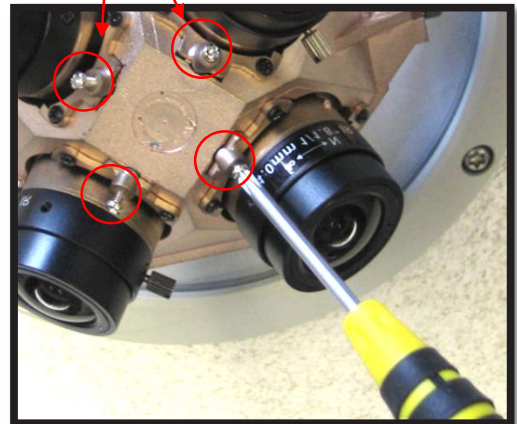

Image 20

H.264 Day/Night SurroundVideo® Pendant Mount SV-CMT Installation Instructions

Inside the box:

- A. Pendant pole
- B. Top shield
- C. Pendant Mount
- D. One double sided hex key
- E. Pack of four (4) wood screws and four (4) dry wall anchors
- F. Mounting template

Not included but needed:

- #2 Phillips head screw driver

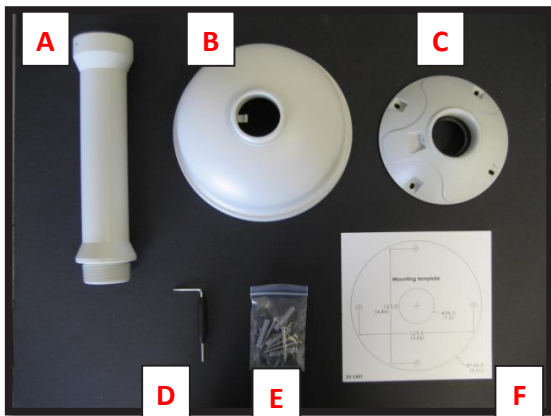

Image 21



Image 22



Image 23

18. Remove Pendant Mount and hardware from the box.
19. Using the Mounting template, prepare the mounting provisions for camera installation.
20. Connect top shield, pendant pole and mount together as shown in **Image 22**.

NOTE: The thread size of top shield, pendant pole and mount is 1.5" NPT.

21. Attach pendant mount to the ceiling using the four wood screws provided or any optional hardware suitable for the mounting surface.
22. Run Ethernet Cable and outside power cable (if necessary) through the Pendant.
23. For installation of the camera shown in **Image 23**, please reference "**Mounting the Camera**".

H.264 Day/Night SurroundVideo® Wall Mount SV-WMT Installation Instructions

Inside the box:

- A. Top shield
- B. Wall mount
- C. One double sided hex key
- D. Pack of four (4) wood screws and four (4) dry wall anchors
- E. Mounting template

Not included but needed:

- #2 Phillips head screw driver

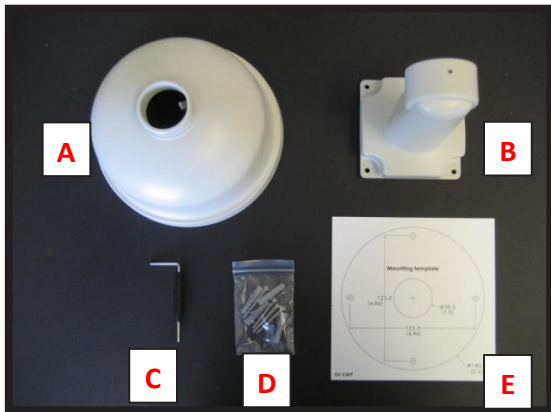

Image 24



Image 25



Image 26

24. Remove Wall Mount and hardware from the box.
25. Using the Mounting template, prepare the mounting surface.
26. Connect top shield and wall mount as shown in **Image 25**.

NOTE: The thread size for Top shield, pendant pole and mount is 1.5" NPT.

27. Run Ethernet Cable and outside power cable (if necessary) through the Wall Mount.
28. Attach Wall Mount to the wall using drywall screws or any optional hardware suitable for the mounting surface.
29. For installation of the camera shown in **image 26**, please reference "**Mounting the Camera**".

H.264 Day/Night SurroundVideo® Flush Mount Adapter Installation Instructions

Inside the box:

- A. White Trim Ring
- B. Flange Plate
- C. Top Plate
- D. Mounting template
- E. Pack of six (6) set screws, three (3) support arms, three (3) lever screws, three (3) screw nuts and caps and one (1) I-Blot

Not included but needed:

- #2 Phillip's head screw driver

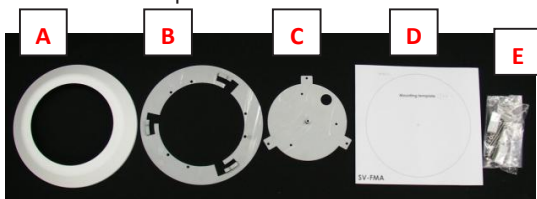

Image 27

30. Remove White Trim Ring, Flange Plate, Top Plate and hardware from the box
31. Attach Flange Plate to in-ceiling mount with 3 set screws as shown in **Image 28**.
32. Attach Top Plate to in-ceiling mount with other 3 set screws as shown in **Image 29**.
33. Insert each lever screw into Flange Plate, support arm, Top Plate, screw nuts and caps as shown in **Image 30**.

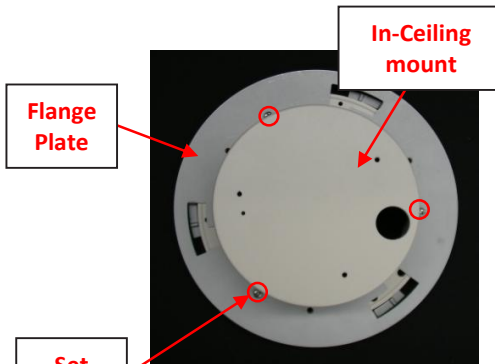

Image 28

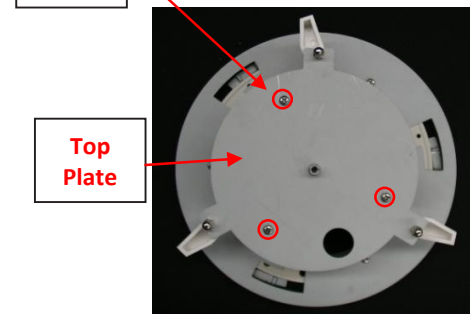

Image 29

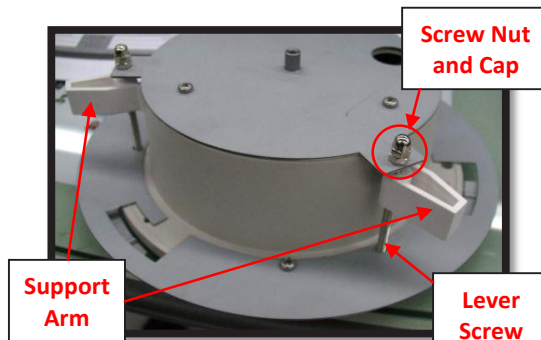

Image 30

34. Using the Mounting template, cut a hole in surface for mounting.
35. Insert Flush Mount Adapter into the hole.
36. Screw the “lever screws” until the flush mount is snugly installed, as shown in **Image 31**. The “Support Arm” will ride down the screw to compress the mounting surface. (**Image 32**)

NOTE: Do not over-torque the lever screws

37. For installation of the camera shown in **image 33**, please reference “**Mounting the Camera**”.
38. Attach the Trim Ring to the Flush Mount Adapter by rotating clockwise as show in **Image 34**.

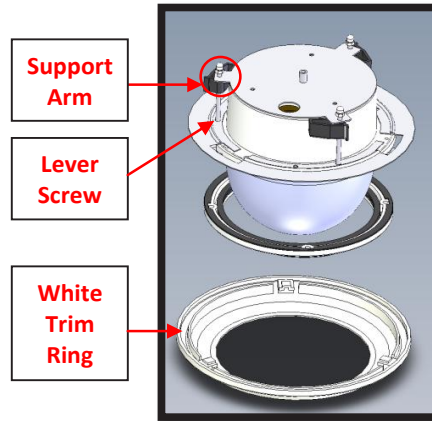

Image 32

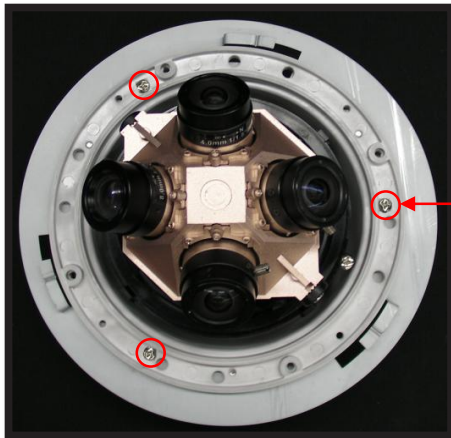

Image 31

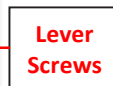

Image 33

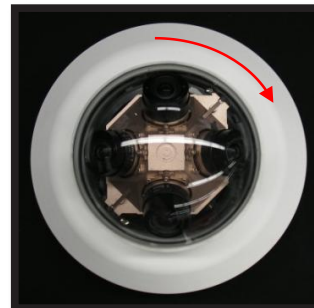

Image 34

H.264 Day/Night SurroundVideo® Pole Mount Adapter Installation Instructions

Inside the box:

- A. Pole Mount Adapter
- B. 2x Compress Fittings
- C. 2x Small Steel Straps
- D. 2x Large Steel Straps
- E. Pack of four (4) machine screws

Not included but needed:

- #2 Phillips head screw driver
- SV-WMT, Wall Mount Adapter

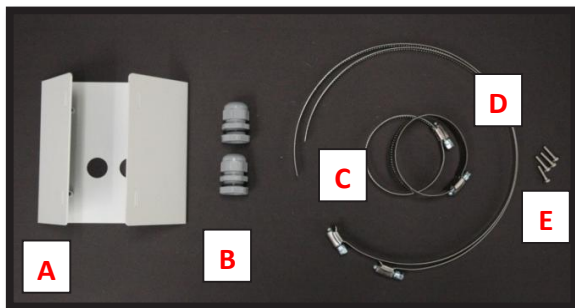

Image 35

NOTE: H.264 Day/Night SurroundVideo® and MegaDome™ share same pole mount adapter, MD-PMA.

39. Remove Pole Mount Adapter, Compress Fittings, Steel Straps and hardware from the box.
40. Install Compress Fittings to Pole Mount Adapter as shown in **Image 36**.



Image 36

41. Attach SV-WMT, Wall Mount Adapter, to Pole Mount Adapter as shown in **Image 37**.
42. Run Ethernet Cable and outside power cable (if necessary) through the Compress Fittings and SV-WMT, Wall Mount Adapter.
43. Use the supplied two Steel Straps to attach the Pole Mount Adapter to the pole and tighten the compression screws (**Image 37**).
44. Attach camera with in-ceiling mount to Wall Mount Adapter. Please reference "**Mounting the Camera**", if needed.
45. Tighten the Compress Fittings to seal the wiring holes.

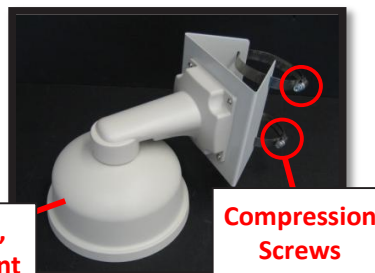

Image 37

H.264 Day/Night SurroundVideo® Corner Mount Adapter Installation Instructions

Inside the box:

- A. Corner Mount Adapter
- B. 2x Compression Fittings
- C. Pack of four (4) machine screws
- D. 2x Packs of four (4) wood screws and four (4) dry wall anchors

Not included but needed:

- #2 Phillips head screw driver
- MegaDome™ Wall Mount Adapter

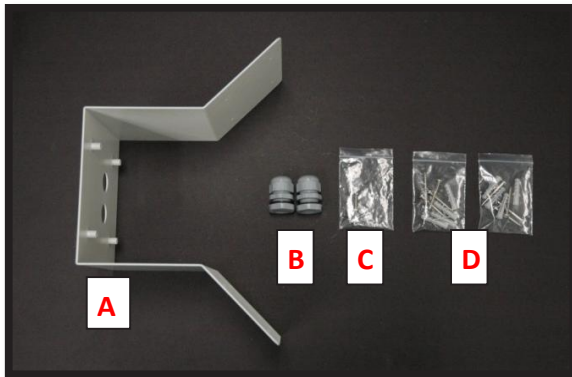

Image 38

NOTE: H.264 Day/Night SurroundVideo® and MegaDome™ share same corner mount adapter, MD-CRMA.

46. Remove Corner Mount Adapter, Compress Fitting and hardware from the box.

47. Install Compress Fittings to Corner Mount Adapter as shown in **Image 39**.

48. Attach Wall Mount Adapter to Corner Mount Adapter as shown in **Image 40**.



Image 39



Image 40

49. Run Ethernet Cable and outside power cable (if necessary) through the Compress Fittings and MegaDome™ Wall Mount.
50. Using the screws provided (or other hardware) attach the Corner Mount Adapter to an exterior 90° corner wall.
51. Attach camera with in-ceiling mount to Wall Mount Adapter. Please reference "**Mounting the Camera**", if needed.
52. Tighten the Compress Fittings to seal the wiring holes.

H.264 Day/Night SurroundVideo® Electrical Box Adapter Installation Instructions

Inside the box:

- A. Electrical Box Adapter
- B. Pack of four (4) machine screws

Not included but needed:

- #2 Phillips head screw driver
- Common Electrical Box, such as single gang box, double gang box, or square electrical boxes shown in **Image 42-1~4**.

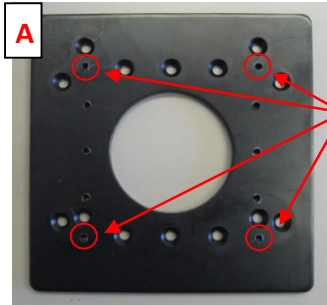

Attach to surface
mount, wall mount or
pendant mount

Image 41

NOTE: H.264 Day/Night SurroundVideo® and MegaView™ share same Electrical Box Adapter, MV-EBA.

- 50. Remove Electrical Box Adapter and hardware from the box.
- 51. Attach H.264 Day/Night SurroundVideo® surface mount, wall mount or pendant mount to Electrical Box Adapter. (**Image 41**)
- 52. Attach Electrical Box Adapter to Electrical Box as shown in **Image 42-1~4**.

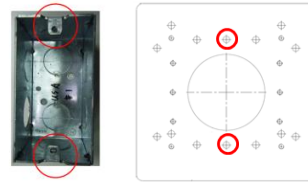

Image 42-1 Single gang box

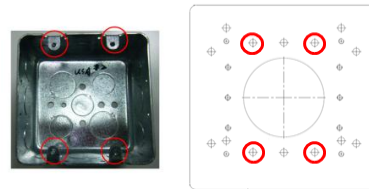

Image 42-2 Double gang box

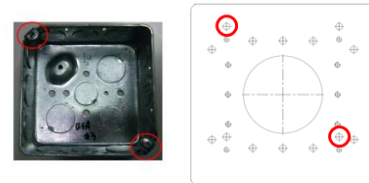

Image 42-3 Square box

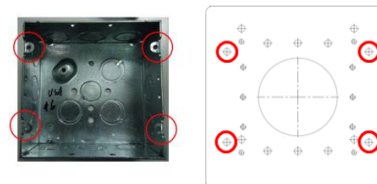

Image 42-4 Square box

Leading
the **way** in
Megapixel
video

Arecont Vision

425 E. Colorado Street, 7th Floor
Glendale, CA 91205

support@arecontvision.com

www.arecontvision.com

+1.818.937.0700

877.CAMERA.8

