

792 / 1792 Ins.

ASSEMBLY

IMPORTANT: Before assembling remove any burrs or flash (if any) from all parts. Burnish (Polish) all friction bearing surfaces with #231 Greas-em dry graphite lubricant.

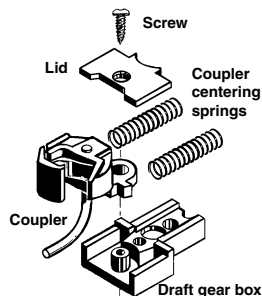

To assemble the coupler follow the illustrations in these instructions. Make sure the gear box lid is tightly secured with the screw. Add a "puff" of our #231 Greas-em into the draft gear box. Make sure the coupler flexes back and forth freely.

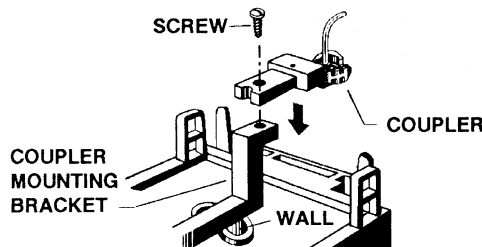
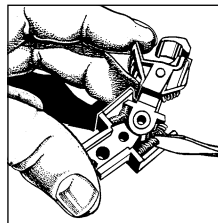

MOUNTING INSTRUCTIONS

1. Remove the old existing coupler.
2. Place the new Kadее® coupler in the same position as the old coupler. Secure with the previously removed original mounting screw or use one of the supplied #4 x 3/8" screws.
3. If coupler draw bar does not re-center properly, you may find excess paint on the coupler mounting bracket guide wall as shown in the above assembly view. This can be scraped off with an X-acto® knife.

COUPLER OPERATION TO COUPLE -

Simply push cars together until knuckles bypass each other and lock into position.

FOR DELAYED UNCOUPLING -

- 1) Stop with the couplers over an uncoupler and back up slightly with the couplers still over the uncoupler, allowing slack to occur between couplers.
- 2) Pull forward slightly. Couplers are now in the delayed position.
- 3) Back up, pushing the car(s) to the desired location. Do not permit slack to develop between couplers.
- 4) Pull forward, leaving the car(s) where desired. Couplers automatically return to normal coupling position.

Use Kadее® Greas-em, the dry lubricant recommended for use with all Kadее® Magne-Matic® couplers. Grease-em will not attract the dirt and dust that gums up the inside of couplers like oil, grease or other lubricants will. Use our #829 #1-Scale or #880 G-Scale Height Gauge to check for the correct coupler height and trip pin clearance. The N.M.R.A. standard for coupler height is the centerline of coupler is 1 1/16" (1.0625") for #1-Scale & 1 1/8" (1.125") G-Scale.

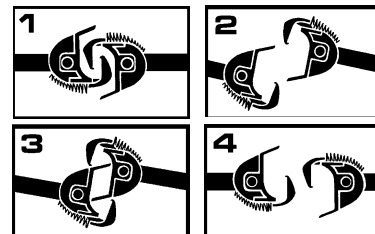

NOTE: If couplers swing open too far when uncoupling, lower magnet slightly to correct.

Note: We include extra knuckle springs. The Replacement Knuckle Spring used on Kadее® #1-Scale couplers are sold as the #875 (#819-828 couplers) or #1875 (1700 & 1800 series couplers) Knuckle Spring. The Knuckle Spring used on Kadее® G-Scale couplers are sold as the #860 Knuckle Spring.

For Delayed Action Uncoupling use our #842 Uncoupler, #848 Portable Uncoupler, or our #840 Uncoupler mounted in LGB track.

Kadее® coupler conversion list & coupler conversions are on the Kadее® web site for your convenience.

www.kadee.com/conv/convpl.htm

MAGNE-MATIC®

Kadее®
Quality products co.

673 Avenue C
White City, OR 97503

Made in the U.S.A.