

COMPONENTS OF MODEL CA12CD/A

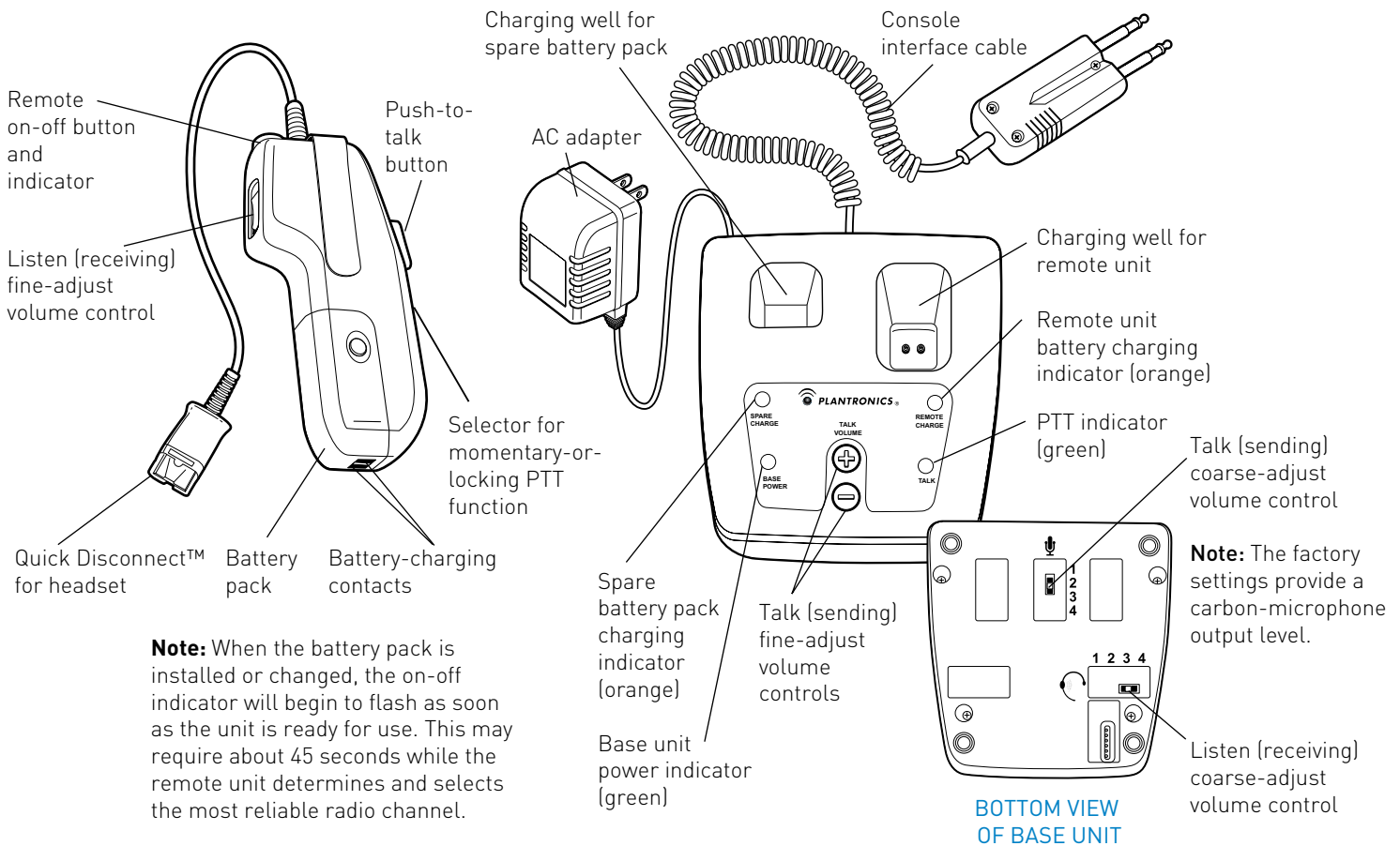

REMOTE UNIT

BASE UNIT

1

Setup

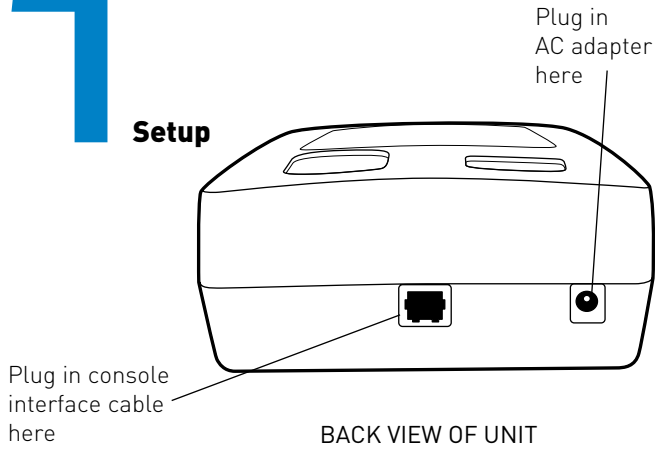

BACK VIEW OF UNIT

1.3, 1.4

- 1.1 Operating other devices in the same frequency band as the CA12CD/A will reduce user density and range. In North America, the CA12CD operates in the UPCS frequency band (1.92 to 1.93 GHz). In other regions, the CA12CD/A operates in the DECT™ frequency band (1.88 to 1.90 GHz). Various versions of the CA12CD/A are available for use in specific countries.
- 1.2 User density and range can vary widely due to such variables as building layout and whether other devices are operating in the same frequency band as the CA12CD/A. In low-density installations (e.g. 5 units placed 3 metres apart), the range can be greater than 3 metres. In high-density installations (e.g. 30 units placed 45.7 centimetres apart), the range could decrease to 3 metres.
- 1.3 Plug the modular connector on the console interface cable into the modular jack on the back of the base unit. Plug the other end into your console.
- 1.4 Plug the AC adapter into the wall outlet, and plug the round power connector into the back of the base unit. The base power indicator will illuminate.
- 1.5 Slide the battery pack onto the remote unit. When the battery pack is installed or changed, the on-off Indicator will begin to flash slowly as soon as the unit is ready for use. This may require about 45 seconds while the remote unit determines and selects the most reliable radio channel.
- 1.6 Attach a headset to the remote unit.
- 1.7 Place CA12CD/As at least 30.5 centimetres away from CRT-type computer monitors.

2

Battery charging & management

- 2.1 To attach the battery pack to the remote unit, simply slide the battery pack onto the remote unit and snap it into place. Do not force them together.
- 2.2 The base unit is equipped with two battery-charging wells. The larger well allows charging of the battery while it is attached to the remote unit. The smaller well allows charging of a spare battery pack all by itself.
- 2.3 Insert the remote unit and the spare battery pack into their respective charging wells. The charging indicators will flash while the battery packs are charging.
- 2.4 When a battery pack is charged, its charging indicator will stop blinking and glow steadily.
- 2.5 The on-off indicator on the remote unit will begin to flash as soon as the unit is ready for use. This may require about 45 seconds while the remote unit determines and selects the most reliable radio channel.
- 2.6 A fully charged battery pack will last for up to eight hours.
- 2.7 To maximise the life of the battery pack, turn the remote unit off and place it into the charging well when not in use. Prior to being used, battery packs must be charged for at least one hour or until the charging indicator changes from blinking to continuously on.
- 2.8 A completely depleted battery requires three hours to fully charge.

Note: Always release (disengage) the PTT button before swapping battery packs.

Warning: Touching the battery-charging contacts or placing objects other than the battery packs and remote unit in the charging wells may adversely affect the operation of the CA12CD/A.

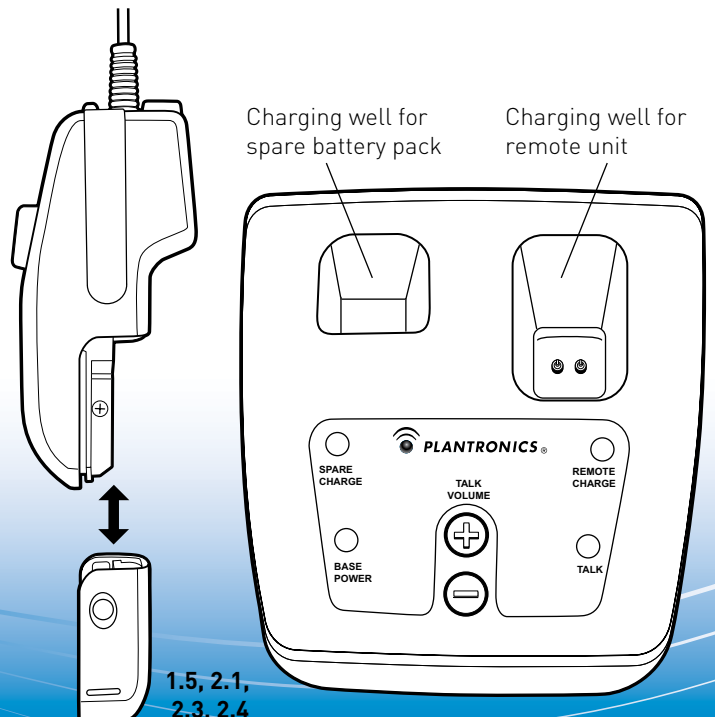

3 Operation

- 3.1** To maximise user density, always turn the remote unit off when not in use.
- 3.2** Press the on-off button located on top of the remote unit. The green on-off indicator will begin to flash. If the battery has just been installed, the remote unit will automatically turn on and the on-off indicator will begin to flash. This may require about 45 seconds. (Reference section 1.5)
- 3.3** Pressing the push-to-talk (PTT) button on the remote unit will generate the "key" signal to your console or radio. While the PTT button is depressed, the green talk indicator on the base unit will illuminate.
- 3.4** The operation of the PTT button can be adjusted with a screwdriver to be either lockable or non-lockable as shown.

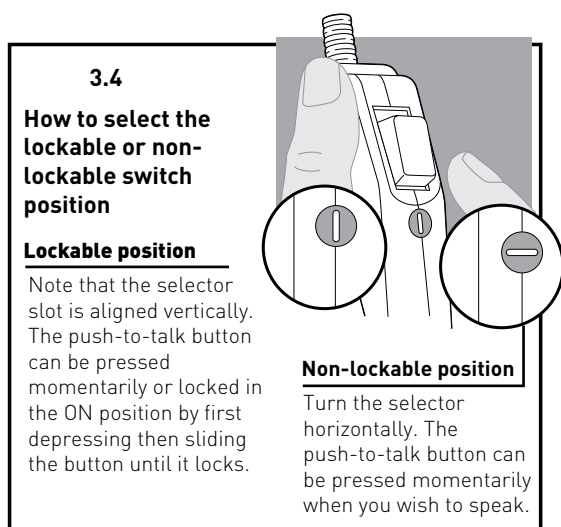

- 3.5** To get the best audio performance from your CA12CD/A, please use the guidelines on the separate card, setting model CA12CD/A audio levels. Properly adjusted audio levels are especially important for avoiding side-tone echo, as well as for being able to hear your callers and be heard clearly by them.
- 3.6** The base unit and the remote unit are paired with each other at the factory in a process called subscription. If you replace your remote unit or if your remote unit loses its subscription (shown by a rapidly flashing on-off indicator), you can perform the subscription process as follows:
- Hold both of the talk (sending) fine-adjust volume controls on the top of the base unit down.
 - The base power indicator will begin blinking.
 - Hold the remote unit's listen (receiving) fine-adjust volume control in either the up or down position.
 - The remote unit's on-off indicator will turn on steadily (no flashing).
 - The remote unit will subscribe to the base unit, after which the base power indicator will return to the steadily on state. The remote unit's on-off indicator will go out for a few seconds and then begin to flash slowly. Your CA12CD/A is now ready to use.

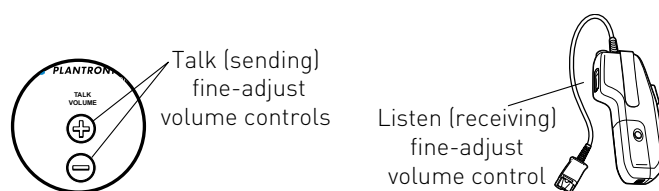

CONTROLS AND INDICATORS

Model CA12CD/A provides numerous audible and visible indications. Detailed descriptions are provided below.

CONTROLS

Name and Location	Function
Push-to-talk button on remote unit	Causes relay closure in base unit that "keys up" user's radio
Locking-momentary selector on remote unit	Enables or disables locking operation of the PTT Switch
On-off button and indicator on remote unit	Toggles the RF link between the idle-locked and enabled states
Listen (receiving) fine-adjust volume control rocker switch on remote unit	Adjusts the listen (receiving) sensitivity in 2-dB steps
Listen (receiving) coarse-adjust volume control slide switch on base unit bottom	Adjusts the listen (receiving) sensitivity in 6-dB steps
Talk (sending) fine-adjust volume control momentary push buttons on base unit top	Adjusts the talk (sending) sensitivity in 2-dB steps
Talk (sending) coarse-adjust volume control slide switch on base unit bottom	Adjusts the talk (sending) output for carbon, electret or dynamic mic applications

VISIBLE INDICATORS

Name	Aspect	Function
Remote unit: green on-off indicator	1) Flashing slowly to conserve battery charge. 2) Flashing rapidly to indicate loss of subscription.	1) Indicates that the RF link between the remote and the base is enabled. 2) Warns of lost subscription when flashing rapidly.
Base unit: green base power indicator	1) On continuously when the base unit is connected to power via the AC adapter. 2) Flashing when base unit is in subscription mode.	1) Shows that the base unit is powered up. 2) Indicates that subscription is occurring.
Base unit: green talk indicator	On steadily when PTT button is depressed.	Shows PTT status.
Base unit: orange charging indicators	1) Flashing while battery is charging. 2) On steadily when battery is fully charged or during top-off charging. 3) Rapidly flashing to indicate a fault condition (remote charge indicator only).	Shows battery and charger status.

ERROR CONDITIONS

If you hear a...	It means...
Triple beep	Your remote unit is too far from the base unit and you should move closer.
Single beep every 10 seconds	Your battery is low and should be changed or charged.
Low-level double beep every 10 seconds	The quality of the link between your remote unit and your base unit is low. (You may be going out of range).
If you see a...	It means...
Rapidly blinking remote on-off Indicator	Your remote unit is not subscribed to the base unit. (Slow blinking indicates normal operation).
Rapidly blinking remote unit battery charging indicator	Your battery should be replaced, or there could be a foreign object in the charging well.

Exposure to radio frequency radiation

This device and its antenna must not be co-located or operated in conjunction with any other antenna or transmitter. To comply with RF exposure requirements, use only the supplied antenna.

The radiated output power of this internal wireless radio is far below radio frequency exposure limits. Nevertheless, the wireless radio shall be used as described in the manual.

The internal wireless radio operates within guidelines found in radio frequency safety standards and recommendations, which reflect the consensus of the scientific community.

Plantronics therefore believes the internal wireless radio is safe for use by consumers. The level of energy emitted is far less than the electromagnetic energy emitted by wireless devices such as mobile phones. However, the use of wireless radios may be restricted in some situations or environments, such as on board aeroplanes. If you are unsure of restrictions, you are encouraged to ask for authorization before turning on the wireless radio.

NOTE: Modifications not expressly approved by Plantronics, Inc. could void the user's authority to operate the equipment.

TECHNICAL ASSISTANCE

Visit our web site at www.plantronics.com/support for technical support including frequently asked questions, compatibility and accessibility information. The Plantronics Technical Assistance Center (TAC) is also ready to assist you on 800-544-4660.

SUPPLIES AND ACCESSORIES

AC Adapters
North America
(shown): 64401-01
European Union:
47249-02
United Kingdom:
64784-01
Australia: 66804-01

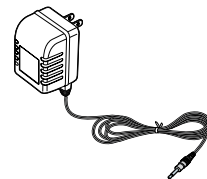

Remote
North America
90224-01
(UPCS)
90224-02
(DECT)



Console interface cable
68331-01

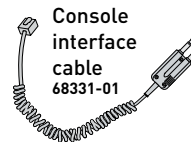

6 wire, modular-to-PJ7 cable assembly

Connectors other than the PJ7 are available upon request

Battery Pack
90225-01

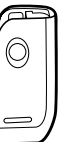

WEEE DISPOSAL INFORMATION

Products labelled with the symbol of a crossed-out wheellie bin as shown below are electrical and electronic equipment. The crossed-out wheellie bin denotes that waste electrical and electronic equipment must not be disposed with the remainder of non-separated household waste, but should instead be collected separately as prescribed by the local laws and regulations. For more detailed information, please refer to our website www.plantronics.com



PLANTRONICS
SOUND INNOVATION™

www.plantronics.com
©2008 Plantronics, Inc. All rights reserved. Plantronics, the logo design, CA12CD/A, Quick Disconnect and Sound Innovation are trademarks or registered trademarks of Plantronics, Inc.
Printed in U.S.A. 79110-01 (12.07)