



## INSTALLATION INSTRUCTIONS FOR PART 99-8218

### APPLICATIONS

# Toyota Camry/Camry Hybrid 2007-up 99-8218

### KIT FEATURES

- DIN radio provision with pocket
- ISO radio provision with pocket
- Double DIN radio provision
- Stacked ISO units provision



### KIT COMPONENTS

- A) Radio Housing
- B) Radio Housing Brackets
- C) ISO Snap-In Brackets
- D) Double DIN Brackets
- E) Trim Plate
- F) Double DIN Trim Plate
- G) Pocket
- H) (4) # 8 x 3/8 Phillips Screws
- I) (4) #4 x 1/4 Phillips Screws

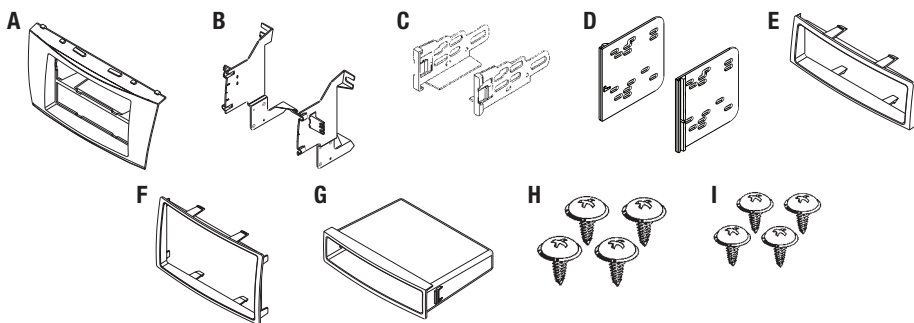

### WIRING & ANTENNA CONNECTIONS (Sold Separately)

- Wiring Harness: • 70-1761 Toyota harness 1987-up  
• TYTO-01 Toyota amp interface 2003-up

Antenna Adapter: • Not Required

### TOOLS REQUIRED

Panel Removal Tool • Phillips Screwdriver • Small Flat Blade Screwdriver • Socket Wrench



**METRA. THE WORLD'S BEST KITS.™**



**1-800-221-0932**



**metraonline.com**

© COPYRIGHT 2004-2011 METRA ELECTRONICS CORPORATION



99-8218

## Table of Contents

### Dash Disassembly

- Toyota Camry/Camry Hybrid 2007-up..... 3-4

### Kit Assembly

- DIN radio provision with pocket..... 5-6
- ISO radio provision with pocket..... 7-8
- Double DIN radio provision..... 9-10
- Stacked ISO units provision..... 11-12

### Caution

*Metra recommends disconnecting the negative battery terminal before beginning any installation. All accessories, switches, and especially air bag indicator lights must be plugged in before reconnecting the battery or cycling the ignition.*

**\*NOTE:** Refer also to the instructions included with the aftermarket radio.



#### KNOWLEDGE IS POWER

Enhance your installation and fabrication skills by enrolling in the most recognized and respected mobile electronics school in our industry. Log onto [www.installerinstitute.com](http://www.installerinstitute.com) or call 800-354-6782 for more information and take steps toward a better tomorrow.



**Metra recommends MECP  
certified technicians**

## Dash Disassembly

1. Turn the shift knob counterclockwise to remove.
2. Unclip and remove (1) trim panel from each side of the pocket below the radio/climate control assembly. (2 panels total) (Figure A)
3. Unclip and remove the shift knob trim panel. (Figure B)
4. Unclip and remove the top of the center console including the cup holders. (Figure B)
5. Remove (1) Phillips screw from each side of pocket below the radio/climate control assembly (2 screws total). (Figure C)
6. Unclip and remove the pocket. (Figure C)

*Continued on next page*

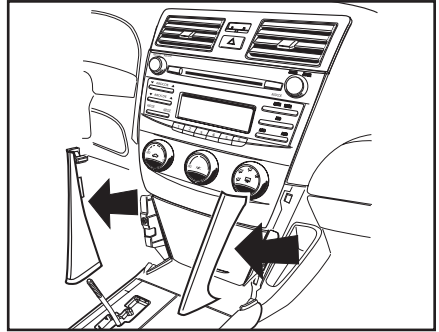

(Figure A)

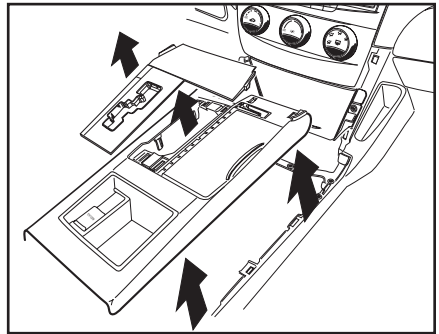

(Figure B)

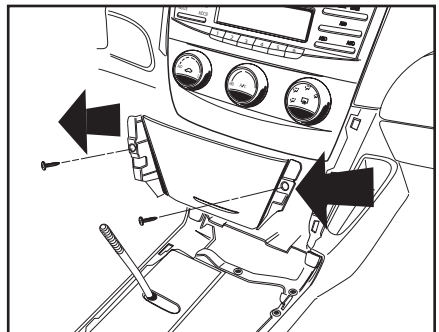

(Figure C)

## Dash Disassembly

7. Unclip and remove the A/C vents above the radio. (Take care not to scratch the dash panel). (Figure D)
8. Remove (2) 10mm bolts above the radio (behind the A/C vents) and (2) 10mm bolts below the climate controls (behind pocket) then unplug and remove the radio/climate control assembly. (Figure E)
9. Remove the (10) Phillips screws securing the brackets to the radio/ climate control assembly and separate the radio from the climate controls. (Retain climate controls and screws for use during kit assembly). (Figure F)
10. Unscrew and remove the (2) Clips from the back of the factory radio. (Retain clips for use during kit assembly). (Figure F)

*Continue to kit assembly*

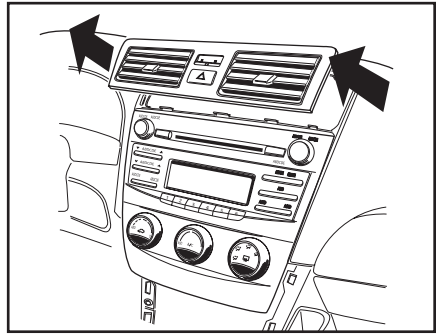

(Figure D)

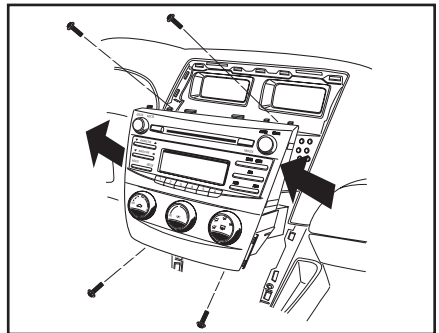

(Figure E)

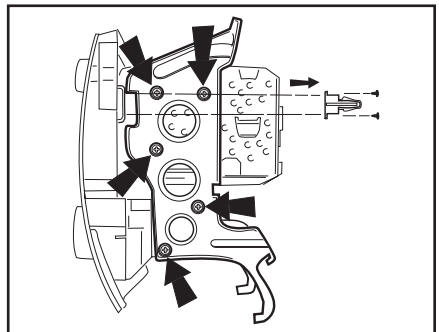

(Figure F)



## Kit Assembly 99-8218

### DIN radio provision with pocket

1. Locate the factory wiring harness in the dash. Metra recommends using the proper mating adapter from Metra or AXXESS. Re-connect the negative battery terminal and test the unit for proper operation.
2. Slide the DIN cage into the Radio Housing and secure by bending the metal locking tabs down. (Figure A)
3. Slide the after-market radio into the cage until it snaps into place. (Figure B)
4. Snap the pocket into the radio housing. (Figure B)
5. Align the small legs on the bottom of the radio housing with the slots in the top of the climate control. Then slide the climate control sideways to engage together. (Figure C)

*Continued on next page*

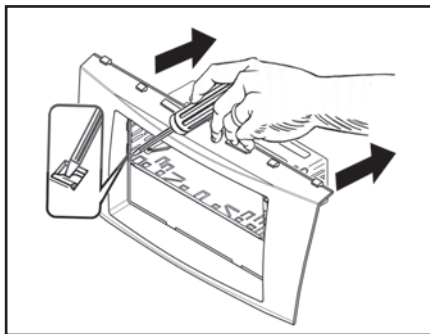

(Figure A)

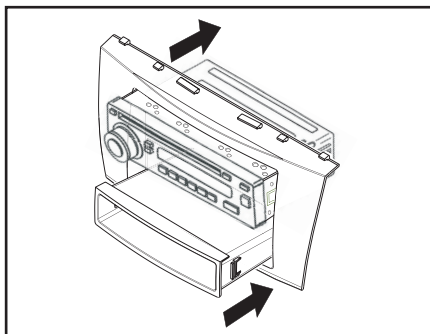

(Figure B)

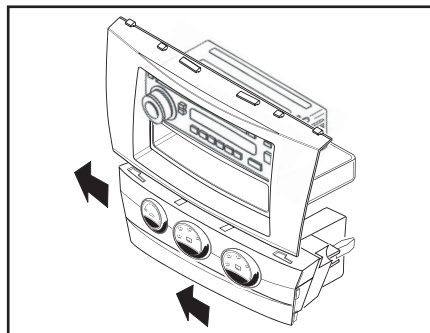

(Figure C)



## Kit Assembly 99-8218

### DIN radio provision with pocket

6. Attach the radio housing brackets to the radio housing using the included Phillips screws. (Figure D)
7. Secure the radio housing brackets to the climate control using the factory hardware. (Figure D)
8. Attach the (2) clips removed in step 11 in dash disassembly to the radio housing brackets using the supplied small Phillips screws. (Figure D)
9. Reassemble dash in reverse order of disassembly.

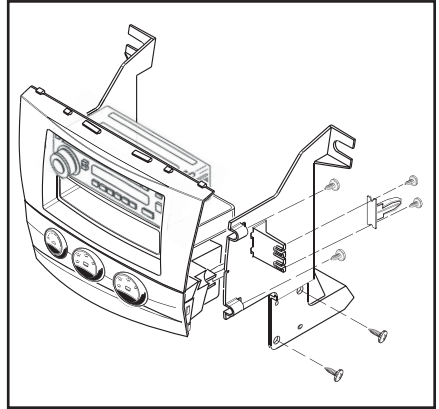

(Figure D)



## Kit Assembly 99-8218

### ISO radio provision with pocket

1. Locate the factory wiring harness in the dash. Metra recommends using the proper mating adapter from Metra or AXXESS. Re-connect the negative battery terminal and test the unit for proper operation.
2. Mount the ISO Brackets to the radio with the screws supplied with the radio. (Figure A)
3. Slide the radio into the radio opening until the side clips engage. (Figure B)
4. Snap the Trim plate into the Radio Housing. (Figure B)
5. Snap the pocket into the radio housing. (Figure B)
6. Align the small legs on the bottom of the radio housing with the slots in the top of the climate control. Then slide the climate control sideways to engage together. (Figure C)

*Continued on next page*

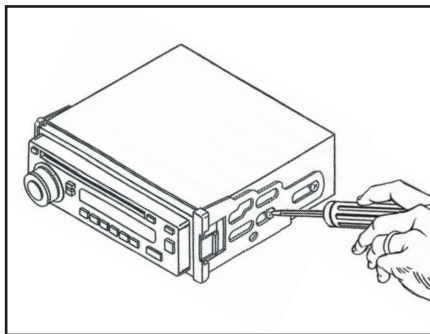

(Figure A)

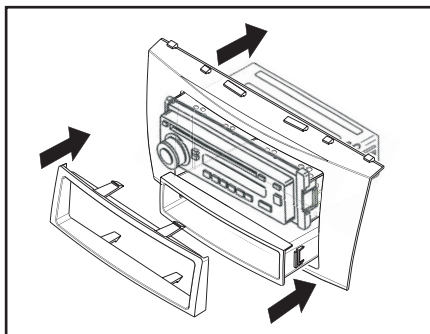

(Figure B)

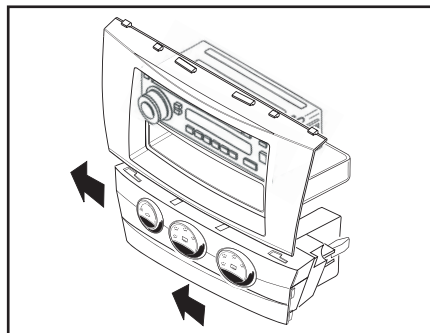

(Figure C)



## Kit Assembly 99-8218

### ISO radio provision with pocket

7. Attach the radio housing brackets to the radio housing using the included Phillips screws. (Figure D)
8. Secure the radio housing brackets to the climate control using the factory hardware. (Figure D)
9. Attach the (2) clips removed in step 11 in dash disassembly to the radio housing brackets using the supplied small Phillips screws. (Figure D)
10. Reassemble dash in reverse order of disassembly.

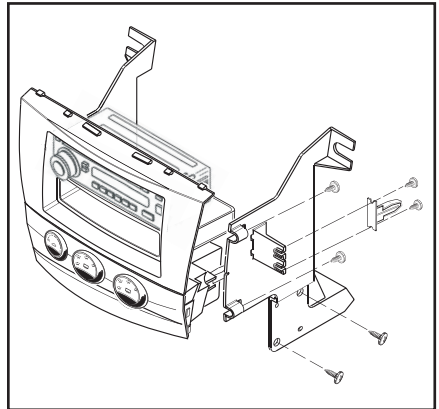

(Figure D)





## Kit Assembly 99-8218

### Double DIN radio provision

1. Locate the factory wiring harness in the dash. Metra recommends using the proper mating adapter from Metra or AXXESS. Re-connect the negative battery terminal and test the unit for proper operation.
2. Cut and remove center divider from radio housing. (Figure A)
3. Snap the Double DIN brackets to the inside edge of the radio housing. (Figure B)
4. Slide the Double DIN radio into the Double DIN bracket/radio housing assembly and secure the radio to the assembly using the screws supplied with the radio. (Figure C)
5. Snap the Double DIN trim-plate into the housing/radio assembly. (Figure C)

*Continued on next page*

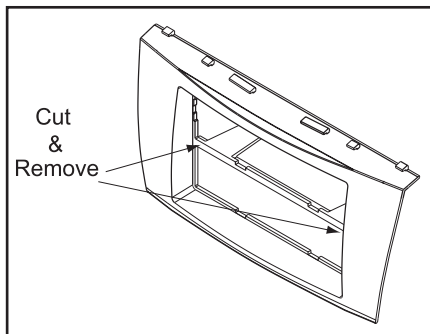

(Figure A)

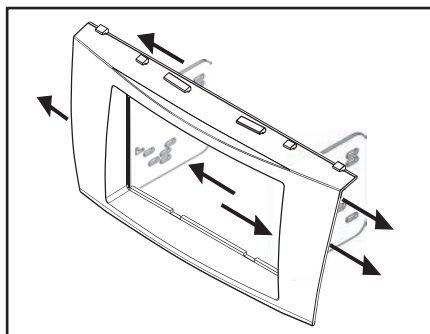

(Figure B)

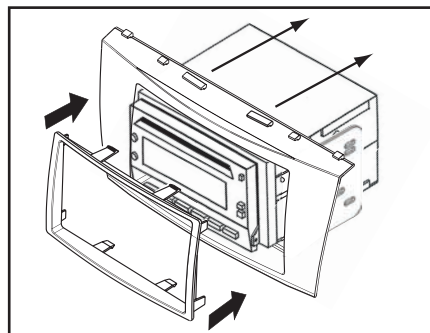

(Figure C)



## Kit Assembly 99-8218

### Double DIN radio provision

6. Align the small legs on the bottom of the radio housing with the slots in the top of the climate control then slide the climate control sideways to engage together. (Figure D)
7. Attach the corresponding radio housing bracket to the radio housing using the included Phillips screws. (Figure E)
8. Secure the radio housing brackets to the climate control using the factory hardware. (Figure E)
9. Attach the (2) clips removed in step 11 in dash disassembly to the radio housing brackets using the supplied small Phillips screws. (Figure E)
10. Reassemble dash in reverse order of disassembly.

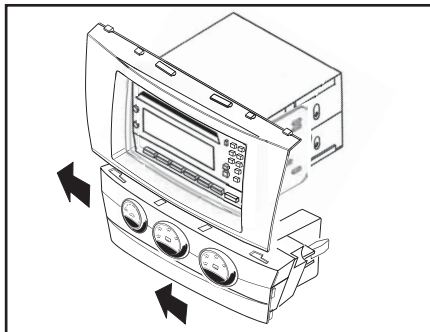

(Figure D)

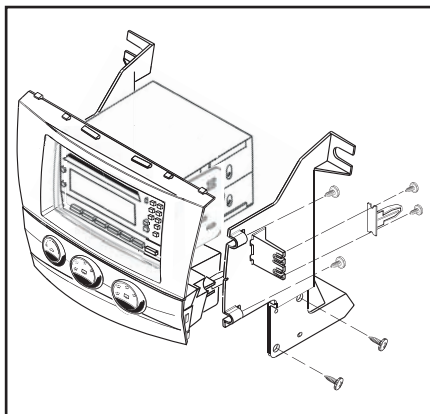

(Figure E)



## Kit Assembly 99-8218

### Stacked ISO units provision

1. Locate the factory wiring harness in the dash. Metra recommends using the proper mating adapter from Metra or AXXESS. Re-connect the negative battery terminal and test the unit for proper operation.
2. Cut and remove center divider from radio housing. (Figure A)
3. Snap the Double DIN brackets to the inside edge of the radio housing. (Figure B)
4. Slide the Stacked ISO units into the Double DIN bracket/radio housing assembly and secure the radio to the assembly using the screws supplied with the units. (Figure C)
5. Snap the Double DIN trim-plate into the housing/radio assembly. (Figure C)

*Continued on next page*

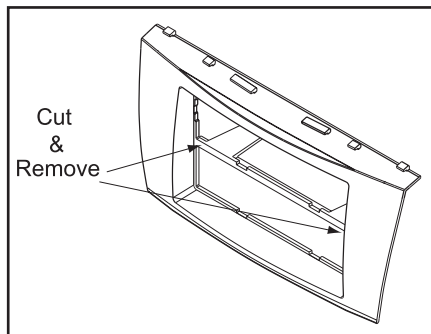

(Figure A)

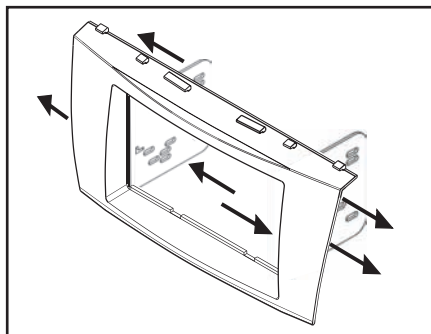

(Figure B)

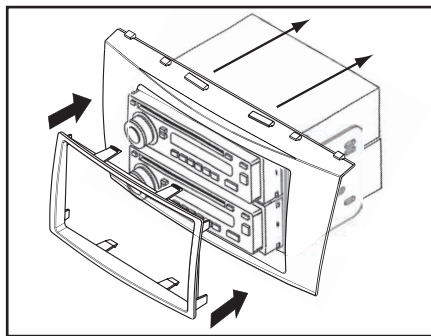

(Figure C)



## Kit Assembly 99-8218

### Stacked ISO units provision

6. Align the small legs on the bottom of the radio housing with the slots in the top of the climate control then slide the climate control sideways to engage together. (Figure D)
7. Attach the corresponding radio housing bracket to the radio housing using the included Phillips screws. (Figure E)
8. Secure the radio housing brackets to the climate control using the factory hardware. (Figure E)
9. Attach the (2) clips removed in step 11 in dash disassembly to the radio housing brackets using the supplied small Phillips screws. (Figure E)
10. Reassemble dash in reverse order of disassembly.

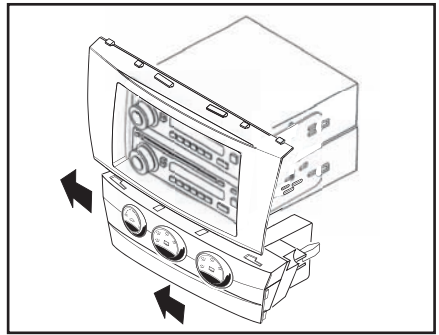

(Figure D)

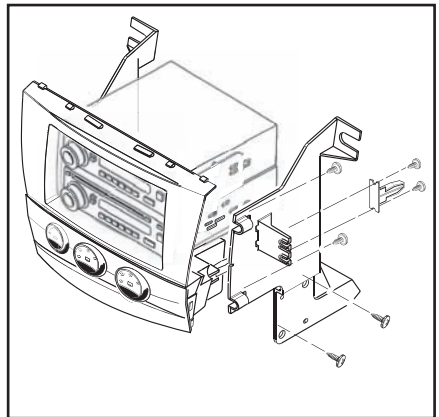

(Figure E)



## Notes

This image shows a single sheet of white paper with horizontal blue ruling lines. The lines are evenly spaced and run across the width of the page. There are no margins, text, or other markings on the paper.





## Notes



## INSTALLATION INSTRUCTIONS FOR PART 99-8218

REV. 5/23/11



**1-800-221-0932**



**metraonline.com**

© COPYRIGHT 2004-2011 METRA ELECTRONICS CORPORATION

**METRA. THE WORLD'S BEST KITS.™**