



## INSTALLATION INSTRUCTIONS FOR PART 99-3305

### APPLICATIONS

#### CHEVROLET

Avalanche 2007-10/Equinox 2007-09  
 Express Van 2008-10/Impala 2006-10  
 Monte Carlo 2006-07/Tahoe 2007-11  
 Silverado 2007-11 (Excluding Classic Models)  
 Suburban 2007-10/Traverse 2009-11

BUICK Enclave 2008-11, Lucerne 2006-10

GMC Acadia 2007-11

Savanna 2008-10

Sierra 2007-11 (Excluding Classic Models)

Yukon 2007-11

HUMMER H2 2008-09

PONTIAC Torrent 2007-09

SATURN Outlook 2007-09/Vue 2008-09

SUZUKI XL7 2007-09

# 99-3305

#### KIT FEATURES

- DIN Radio Provision with Pocket
- ISO Radio Provision with Pocket



#### KIT COMPONENTS

- A) Radio Housing • B) ISO Brackets • C) Trim Plate

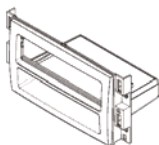
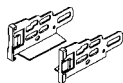
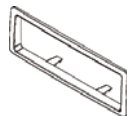
**A****B****C**

#### WIRING AND ANTENNA CONNECTIONS:

(Sold Separately)

Harness:

- GMOS-LAN-01 - GM LAN interface 2006-up
- GMOS-LAN-02 - GM LAN amplified interface 2006-up

Antenna Adapter:

- 40-CR10 - Chrysler/GM antenna adapter 2002-up

#### TOOLS REQUIRED:

Small Flat Blade Screwdriver • Panel Removal Tool



• Phillips  
Screwdriver

**1-800-221-0932****www.metraonline.com**

© COPYRIGHT 2004-2010 METRA ELECTRONICS CORPORATION



**TABLE OF CONTENTS**

**Dash Disassembly**

- Chevrolet Impala 2006-2010. .... 1
- Chevrolet Monte Carlo 2006-2007 .....1
- Buick Lucerne 2006-2010 ..... 1
- Chevrolet Avalanche 2007-2010 ..... 2
- Chevrolet Silverado (Excluding Classic Models) 2007-2011 ..... 2
- Chevrolet Suburban 2007-2010 .....2
- Chevrolet Tahoe 2007-2011 .....2
- GMC Sierra (Excluding Classic Models) 2007-2011 ..... 2
- GMC Yukon 2007-2011 .....2
- Chevrolet Express Van 2008-10/GMC Savanna 2008-2010 ..... 3
- Suzuki XL-7 2007-2009 .....4
- Chevrolet Equinox 2007-09/Pontiac Torrent 2007-2009 ..... 5
- Buick Enclave2008-11/ GMC Acadia2007-11/Saturn Outlook 2007-09 ..... 6
- Hummer H2 2008-2009 .....7
- Saturn Vue 2008-2009..... 8

**Kit Assembly**

- DIN Radio Provision with Pocket ..... 9
- ISO Radio Provision with Pocket ..... 9

- Final Assembly** ..... 10

**\*Note:**

**Refer also to the instructions included with the aftermarket radio.**



**KNOWLEDGE IS POWER**

Enhance your installation and fabrication skills by enrolling in the most recognized and respected mobile electronics school in our industry. Log onto [www.installerinstitute.com](http://www.installerinstitute.com) or call 800-354-6782 for more information and take steps toward a better tomorrow.

**BUICK LUCERNE / CHEVY IMPALA 2006-10**  
**MONTE CARLO 2006-07**

- 1 Disconnect the negative battery terminal to prevent an accidental short circuit.
- 2 Unclip and remove the trim panel around radio and a/c control.  
(Figure A)

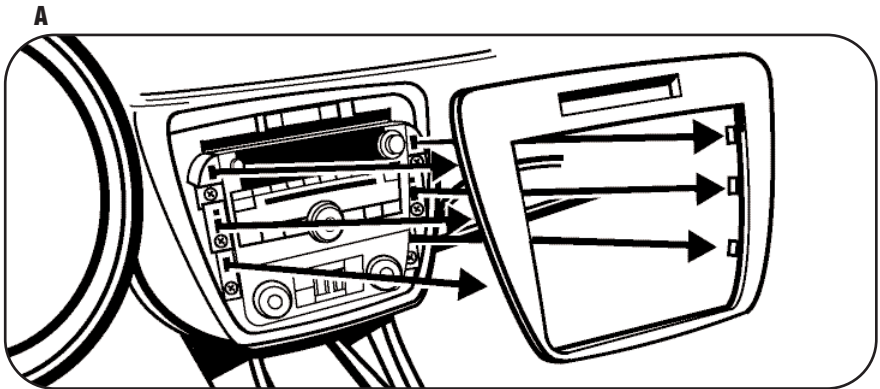

- 3 Remove (6) 9/32" screws to extract radio and a/c control from sub dash.  
(Figure B)

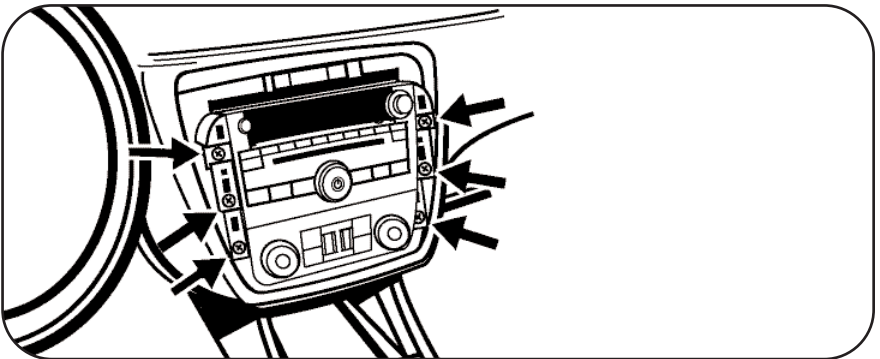

*Continue to kit assembly.*

## SILVERADO (Excluding Classic Models)/SUBURBAN CHEVY AVALANCHE/TAHOE

### GMC YUKON/SIERRA (Excluding Classic Models) 2007-11

*\*Note: Refer also to the instructions included with the aftermarket radio.*

- 1 Disconnect the negative battery terminal to prevent an accidental short circuit.
- 2 Unclip and remove radio trim panel. (Figure A)
- 3 Remove (2) 8mm screws securing switch panel below climate controls. Unplug and remove switch panel. (Figure B)
- 4 Remove (2) 8mm screws securing climate controls. Unplug and remove climate controls. (Figure B)
- 5 Remove (4) 9/32" screws securing radio. Unplug and remove the radio. (Figure C)

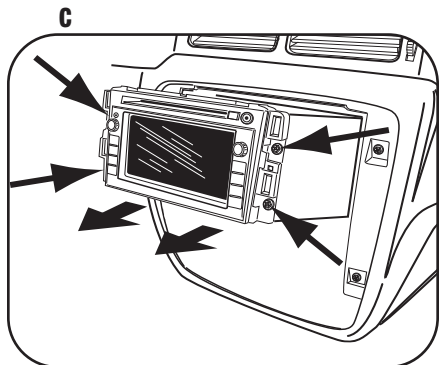
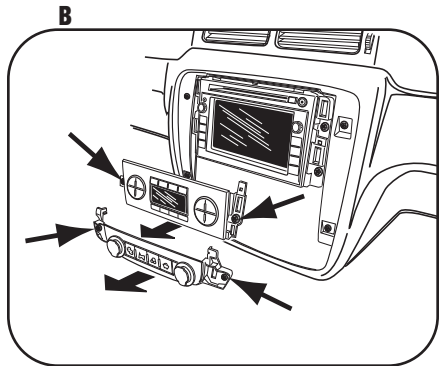
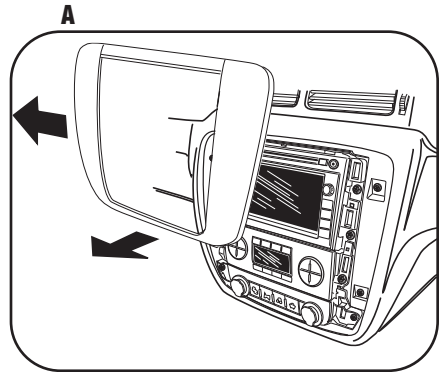

*Continue to kit assembly.*

## **CHEVY EXPRESS VAN 2008-10/GMC SAVANNA 2008-10**

*\*Note: Refer also to the instructions included with the aftermarket radio.*

- 1 Disconnect the negative battery terminal to prevent an accidental short circuit.
- 2 Remove (2)10mm bolts from below knee bolster under steering column and remove panel.
- 3 Remove (2)10mm bolts from panel below passenger dash airbag and remove panel.
- 4 Unsnap and remove radio and instrument cluster panel. (May not be necessary to completely remove radio and instrument cluster panel to access radio.)
- 5 Remove (4) 9/32" bolts to remove radio.

*Continue to kit assembly.*

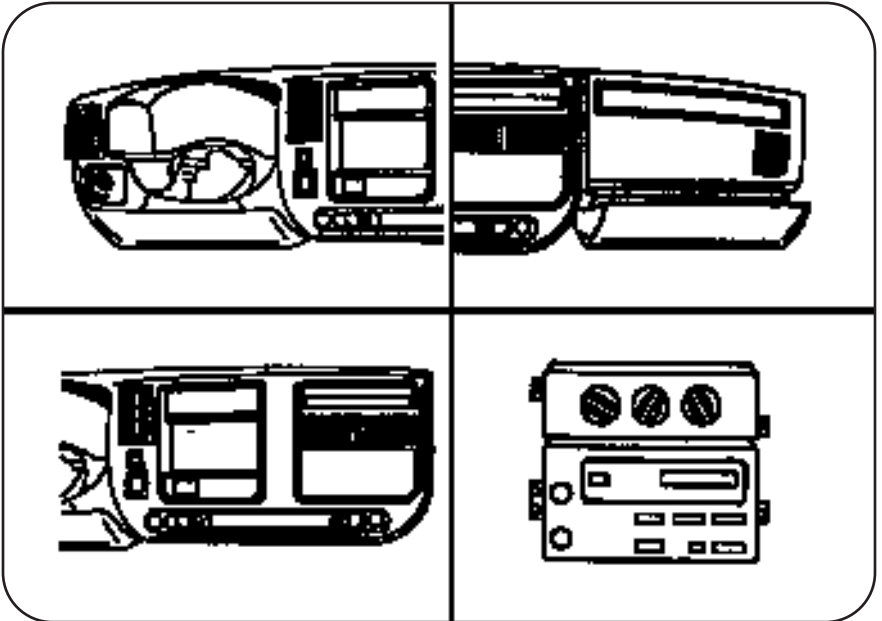

**SUZUKI XL-7 2007-09**

*\*Note: Refer also to the instructions included with the aftermarket radio.*

**1** Disconnect the negative battery terminal to prevent an accidental short circuit.

**2** Press in on sides of the shifter boot to release it from the shifter trim panel. (Figure A)

**3** Lift the boot up to access the Allen screw securing the shifter knob to the shifter lever. Loosen the Allen screw and remove the shifter knob.

**4** Remove (1) torx screw from the shifter trim panel (Figure C), then using a panel removal tool unsnap the shifter trim panel. Unplug and remove the panel. (Figure D)

**5** Using a panel removal tool unsnap the radio trim panel. Unplug and remove the panel. (Figure E)

**6** Remove (4) 9/32" screws securing the radio. Unplug and remove the radio.

*Continue to kit assembly.*

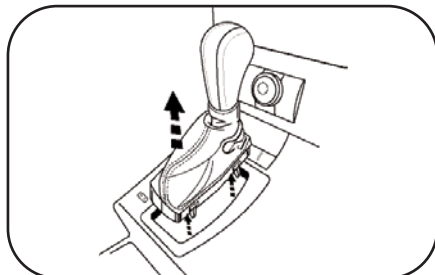
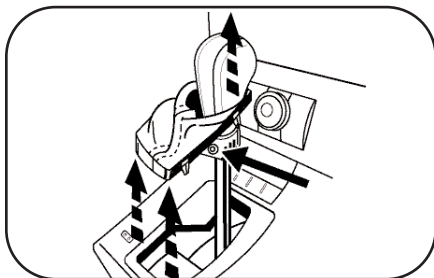
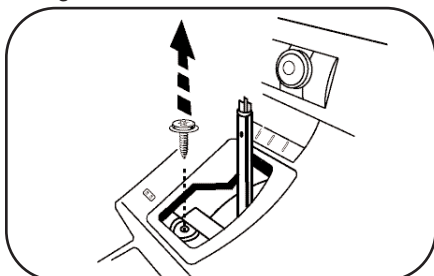
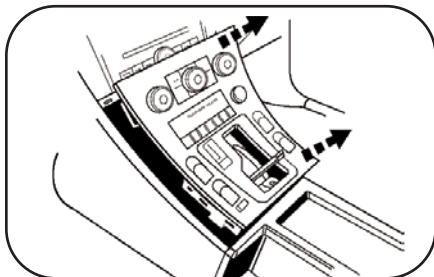
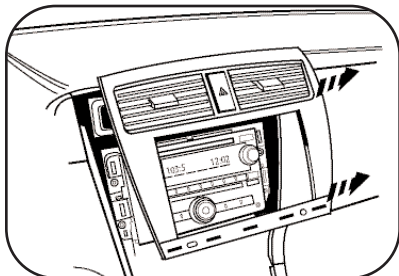
**A**

**B**

**C**

**D**

**E**

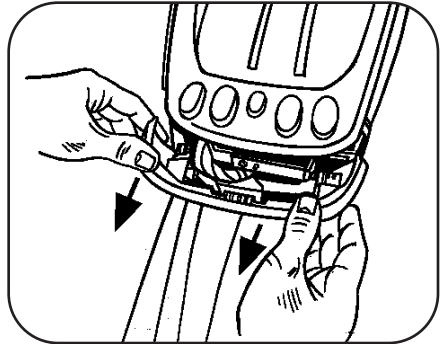
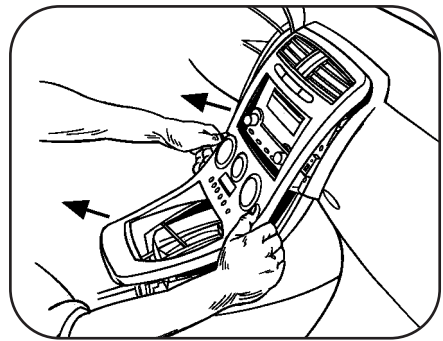
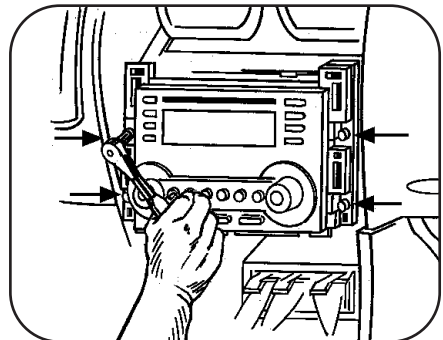
**CHEVROLET EQUINOX 2007-09**
**PONTIAC TORRENT 2007-09**

*\*Note: Refer also to the instructions included with the aftermarket radio.*

- 1 Disconnect the negative battery terminal to prevent an accidental short circuit.
- 2 Unsnap panel below power window switch and remove. **Note:** This allows you to unplug the window switch easier. (Figure A)
- 3 Unsnap and remove entire panel surrounding radio and shifter. (Figure B)
- 4 Remove (4) 9/32 screws securing radio. Unplug and remove the radio. (Figure C)

*Continue to kit assembly.*

**A**

**B**

**C**

**BUICK ENCLAVE/GMC ACADIA/SATURN OUTLOOK 2007-10**  
**CHEVY TRAVERSE 2009-11**

*\*Note: Refer also to the instructions included with the aftermarket radio.*

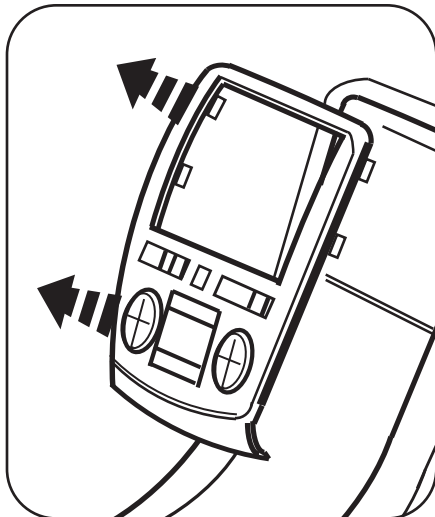
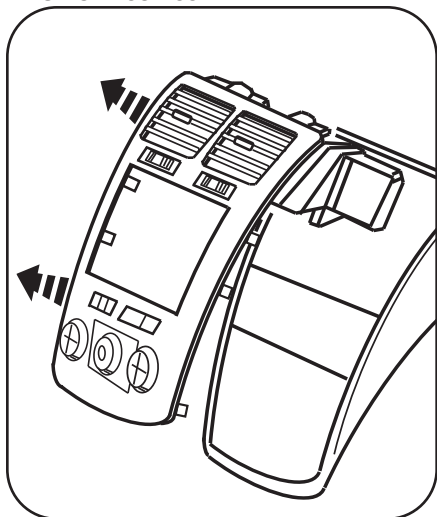
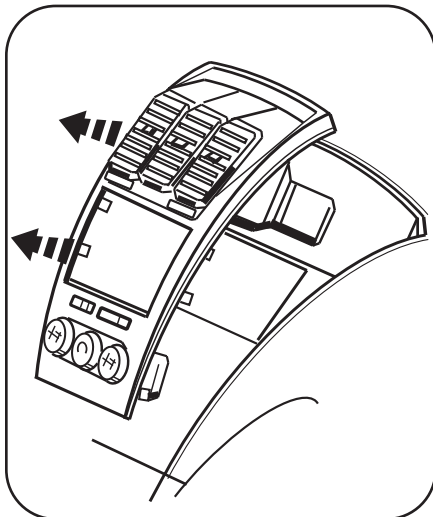
- 1 Disconnect the negative battery terminal to prevent an accidental short circuit.
- 2 Unclip the radio trim panel including the climate controls. Unplug the climate controls and remove the panel. (See drawings)
- 3 Remove (4) 9/32 screws securing the radio. Unplug and remove the radio.

*Continue to kit assembly.*

**BUICK ENCLAVE / CHEVY TRAVERSE****SATURN OUTLOOK****GMC ACADIA**



**HUMMER H2 2008-09**

*\*Note: Refer also to the instructions included with the aftermarket radio.*

- 1** Disconnect the negative battery terminal to prevent an accidental short circuit.
- 2** Unclip the radio trim panel including the a/c vents. Unplug any harnesses connected to the panel and remove the panel. (Figure A)
- 3** Remove (4) 9/32" screws securing the climate controls. Unplug and remove the climate controls.
- 4** Remove (4) 9/32 screws securing the radio. Unplug and remove the radio.

*Continue to kit assembly.*

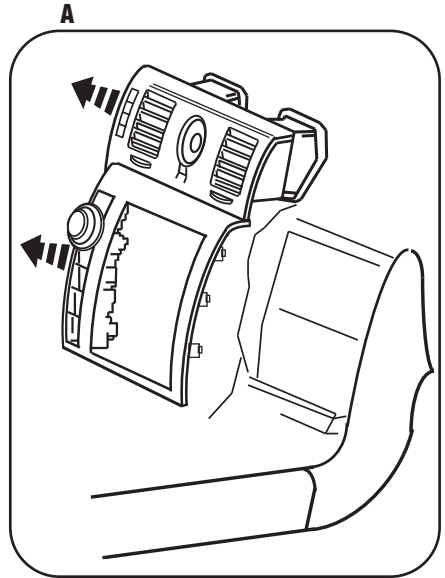

**SATURN VUE 2008-09**

***\*Note: Refer also to the instructions included with the aftermarket radio.***

- 1** Disconnect the negative battery terminal to prevent an accidental short circuit.
- 2** Unclip and remove the trim panel on top of the radio trim panel. (Figure A)
- 3** Remove (2) Phillips screws exposed under panel removed in step 2. (Figure B)
- 4** Unclip and remove the radio trim panel including the a/c vents. (Figure B)
- 5** Unclip and remove the trim panel surrounding the shifter including the climate controls. (Figure C)
- 6** Remove (4) 9/32 screws securing the radio. Unplug and remove the radio.

*Continue to kit assembly.*

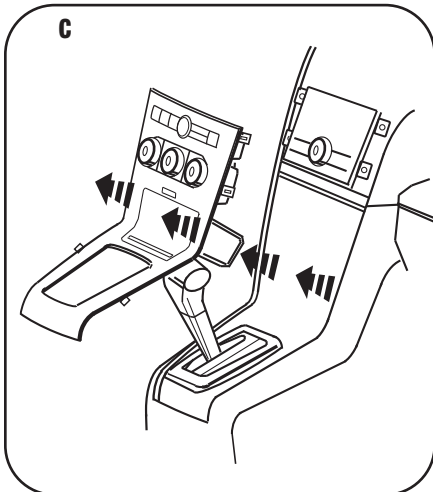
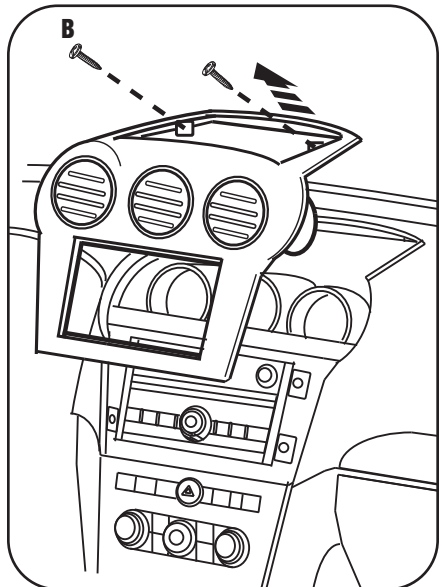
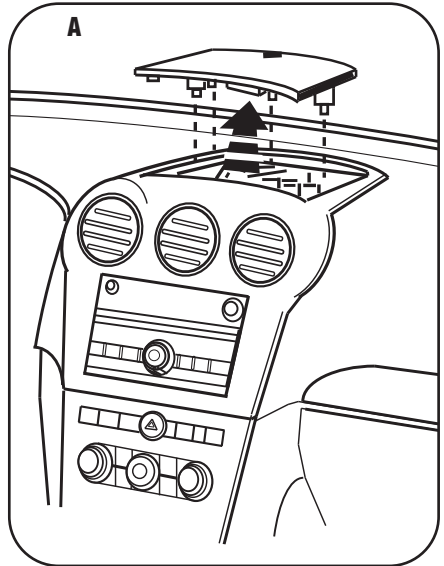

## DIN RADIO PROVISION

*\*Note: Refer also to the instructions included with the aftermarket radio.*

**NOTE: XL-7 ONLY**

Trim top corners of radio housing.  
(Figure A)

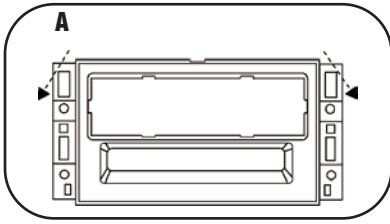

- 1 Slide the DIN cage into the Radio Housing and secure by bending the metal locking tabs down. (Figure B)
- 2 Slide the aftermarket radio into the cage and secure. (Figure C)

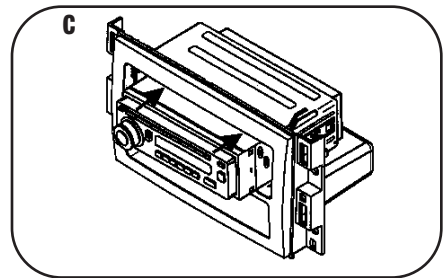
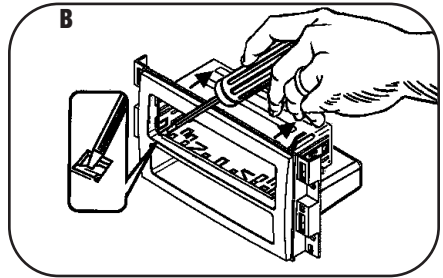

## ISO RADIO PROVISION

**NOTE: XL-7 ONLY**

Trim top corners of radio housing.  
(Figure A)

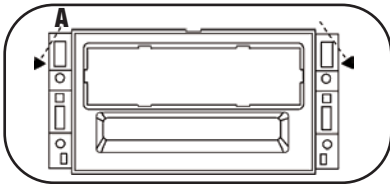

- 1 Mount the ISO Brackets to the radio with the screws supplied with the unit. (Figure B)
- 2 Slide the radio into the radio opening until the side clips engage. (Figure C)
- 3 Snap the Trim plate into the Radio Housing. (Figure C)

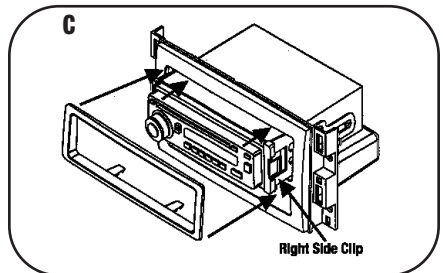
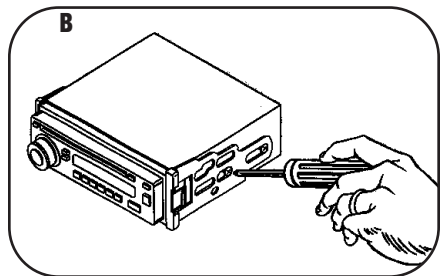

*Continue to final assembly.*

# FINAL ASSEMBLY

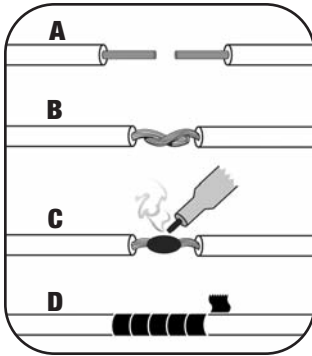

- (A) Strip wire ends back 1/2"**
- B) Twist ends together**
- C) Solder**
- D) Tape**

- 1** Locate the factory wiring harness in the dash. Metra recommends using the proper mating adapter and making connections as shown. (Isolate and individually tape off the ends of any unused wires to prevent electrical short circuit.)
- 2** Re-connect the negative battery terminal and test the unit for proper operation.
- 3** Reassemble radio and dash assemblies in reverse order of disassembly.

## FINAL WIRING CONNECTIONS

Make wiring connections using the EIA color code chart shown below and the instructions included with the head unit. Metra recommends making connections as shown below; Strip, Splice, Solder, Tape. Isolate and individually tape off ends of any unused wires to prevent electrical short circuit.

### METRA / EIA WIRING CODE

12V Ignition / Acc. . . . . Red	Right Front (+) . . . . . Gray
12V Batt / Memory . . . . . Yellow	Right Front (-) . . . . . Gray/ Black
Ground . . . . . Black*	Left Front (+) . . . . . White
Power Antenna . . . . . Blue	Left Front (-) . . . . . White / Black
Amp Turn-On . . . . . Blue / White	Right Rear (+) . . . . . Violet
Amp Ground . . . . . Black / White	Right Rear (-) . . . . . Violet / Black
Illumination . . . . . Orange	Left Rear (+) . . . . . Green
Dimmer . . . . . Orange / White	

**\*NOTE:** When a Black wire is not present, ground radio to vehicle chassis.  
All colors may not be present on all leads due to manufacturer's specifications.