

Operating Speaker

1.Connect

Open speaker of bluetooth interface side (with attached Mini USB cable), and connect to speaker of power interface side (with mini USB port).

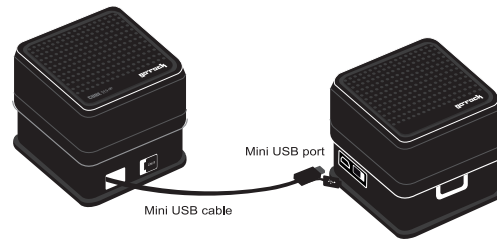

2. Pair and connection the go-rock CUBE speaker

go-rock CUBE speaker is in pairing mode when power is on. Bluetooth blue LED will flash 3 times and you can hear a rising tone. Operate your bluetooth mobile phone or other Bluetooth device to start Bluetooth function. Find the " go-rock CUBE ", press the pairing code " 0000 ", The blue LED (bluetooth interface side) would start flashing , the go-rock CUBE will be the connected mode.

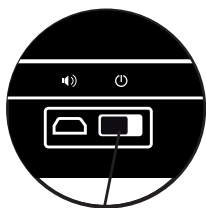

Power on

Your Bluetooth device

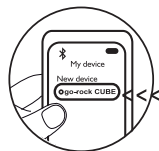

> Select " go-rock CUBE "

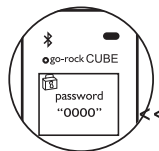

> Press the pairing code
" 0000 "

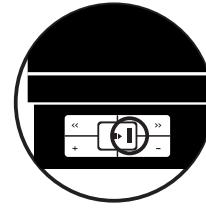

>Blue LED turn on steady when standby(no connection).

>Blue LED is start flashing when bluetooth linked.

3. SRS 3D Surround Mode

Press Vol **[+]** over 1sec - Toggle go-rock CUBE speaker SRS 3D mode



4. Charging Speaker

Power LED Indicator in dim blue : Power status in low power , may need to recharge.

Supply 2 Power Ways

1. Re-Charging on Li battery

Recharging via the built-in USB cable

2. Charge via PC/NB or wall outlet via USB AC adapter

Plug USB cable into a USB 2.0 port on your computer or other USB adapter.

>> Power LED indicator in steady red: in charging mode

>> Power LED indicator goes off: fully charged

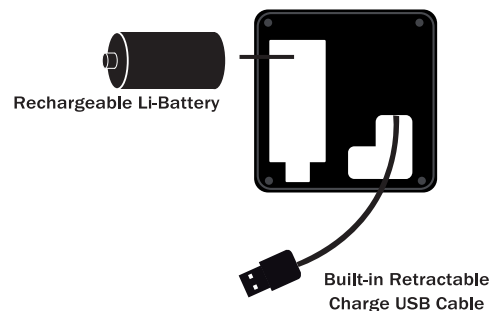

Notice: For battery replacement-

Recommended for quality: Li-ion rechargeable cell battery / 3.7V / 650mAh