

# ECD260

## Indoor Color Mini Dome Camera



### Features

- 420 TVL For Crisp Clear Images
- Ideal for ceiling mounting
- Compact size for discreet surveillance



### Specifications

Part Number	ECD260
Pickup Device	1/3" SONY Super HAD CCD Sensor
Video Format	NTSC or Pal
Picture Elements	510 x 492 (NTSC)   510 x 492 (NTSC)
Scanning System	2:1 Interlace
Horizontal Resolution	420 TVL
Sensitivity	0.1 LUX / F2.0
S/N Ratio	Over 48dB (AGC off)
Electronic Shutter	1/60s~1/100,000s
Video Output	BNC 1.0Vp-p 75Ω
Gamma Correction	0.45
Lens Type	3.6mm F2.0
Lens Options	Board Lens
Gain Control	Auto
White Balance	ATW (2500°K~9500°K)
Sync Mode	Internal Sync
Environmental	Indoor Applications
Power Source	12VDC
Power Consumption	12VDC: 1.2W max.
Operating Temp	14°F~122°F   -10°C~50°C
Dimensions (in   mm)	4" x 2.4"   100 x 60mm
Weight (lbs   gm)	0.23lbs   103g
Certifications	CE/FCC

### Dimensions: mm/in

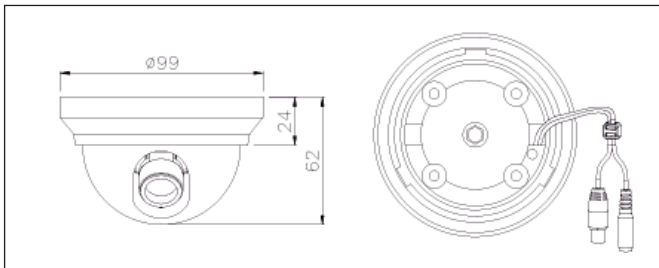

### Ordering Info

**ECD260:** Color Mini Dome, 420 TVL, White, 3.6mm

