

EHN3200

2 Megapixel Outdoor Day/Night Dome Camera



Features

- H.264 encoding/decoding at real-time HD resolution at up to 1080p at 25 FPS
- 2.0 Megapixel CMOS image sensor with full 1080p (1920x1080) resolution
- 12VDC and Power Over Ethernet (PoE) IEEE 802.3af
- BNC test monitor output for the convenience of quick focus and diagnostics right at the camera site
- Vandal and Weather Resistant
- Built-in SD memory card slot for local storage (supports SDHC)
- Smart Wizard settings for various event & schedule recordings



Specifications

Part Number	EHN3200
Pickup Device	10mm (1/2.5") Progressive scan CMOS
Effective Pixels	1920 x 1080
Sensitivity	0.4 Lux/F=1.2
Day/Night	Yes, with IR cut filter
Lens	2.8-10mm/F=1.2 DC vari-focal lens
Video Output	BNC socket, composite 1Vp-p/75ohm For cameras Set-up and test only
Video Resolution	NTSC:1080P (1920x1080), 1140x1080, 720P (1280x720, 1024X768, 4CIF (720x480), 720x576, 704x480, 704x576, VGA (640X480), CIF (352X240), QVGA(320X240), QCIF(176X144)
Compression Setting	CBR (Constant Bit Rate): 7 steps, VBR (Variable Bit Rate): 5 steps
Video Compression	H.264/MPEG4
Frame Rate	Single stream: 30 FPS at 1080p, Dual Stream: up to 2x 30 FPS at lower resolution
Interface	10Base-T/100Base-TX auto-negotiation, FJ-45 socket. Supports MDI/MDI-X auto cross function
Supported Protocols	HTTP, TCP/IP, FTP, SMTP, DHCP, DNS, DDNS, NTP
Max Client Limit	32 clients simultaneously
Power Over Ethernet	Yes (PoE 802.3af)
Alarm Input	1
Alarm Output	1
Audio In/Out	3.5mm mono line input/ line out
Operation Mode	Two-way audio
Event Trigger	Alarm Input, Manual Trigger, Motion Detection and Schedule Recording
Notification	Trigger alarm output, email notification, upload video to FTP, record video to SD card, record video to PC and network alarm
SD Card	Supports SDHC for local storage
Power Supply	12VDC or PoE
Power Consumption	5W max.
Weight	1.6 lbs
Dimension	5" x 4.4"
Operating Temp	-10°C- 50°C/ 14°F - 122°F
Humidity	20%-80%
Rating	IP66 Weather Resistant
Support	ONVIF, PSIA
Certifications	CE, FCC, RoHS

Dimensions: mm/in

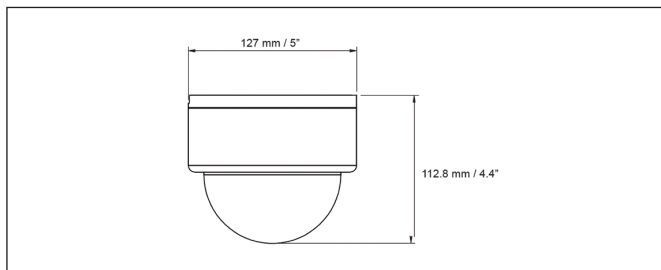

Ordering Info

EHN3200: IP Dome, 2 MP, 3.3-10mm

