

Emeril™



Instructions for Use
T-fal

IMPORTANT SAFEGUARDS

When using an electrical appliance, basic safety precautions should always be followed, including the following:

1. Read all instructions before using.
2. Do not touch hot surfaces. Use handles or knobs.
3. To protect against electric shock, do not immerse cord, plugs or appliance in water or other liquid.
4. Not intended for use by children. Close supervision is necessary for any appliance being used by or near children.
5. Unplug from outlet when not in use and before cleaning. Allow to cool before putting on or taking off parts, and before cleaning the appliance.
6. Do not operate the appliance with a damaged cord or plug or after the appliance malfunctions, or has been damaged in any manner. Return the appliance to the nearest authorized service facility for examination, repair or adjustment.
7. The use of accessory attachments not recommended by the appliance manufacturer may cause injuries.
8. Do not use outdoors.
9. Do not let the cord hang over the edge of a table or counter, or touch hot surfaces.
10. Do not place on or near a hot gas or electric burner, or in a heated oven.
11. Do not use the appliance for other than intended use.
12. Before use, check that your local voltage corresponds with the specifications shown on the appliance nameplate located under the appliance.
13. Extreme caution must be used when moving an appliance containing hot oil or other hot liquids.
14. The temperature of accessible surfaces may be high when the appliance is operating.
15. Check that the electrical installation is compatible with the wattage and voltage stated on the bottom of the appliance.
16. If this appliance has a polarized plug (one blade is wider than the other), it is to reduce the risk of electric shock. This plug is intended to fit into a polarized outlet only one way. If the plug does not fit fully into the outlet, reverse the plug. If it still does not fit, contact a qualified electrician. Do not attempt to modify the plug in any way.
17. To disconnect the appliance, turn any control to min position, then remove plug from the wall outlet.

SAVE THESE INSTRUCTIONS.

Safety instructions

- Never leave the appliance unattended when in use.
- Do not immerse the appliance in water.
- Do not immerse the appliance, the control panel or power cord in water.
- To prevent the appliance from overheating, do not place it in a corner or against a wall.
- Never leave the appliance plugged in when not in use.
- Do not place the hot plate under water or on a fragile surface.
- If you have any problems, contact the authorized after-sales service center or the internet address www.t-falusa.com.

Short Cord instructions

A short power-supply cord (or detachable power-supply cord) is to be provided to reduce the risk resulting from becoming entangled in or tripping over a longer cord.

Longer detachable power-supply cords or extension cords are available and may be used if care is exercised in their use.

If a long detachable power-supply cord or extension cord is used :

- 1) The marked electrical rating of the cord or extension cord should be at least as great as the electrical rating of the appliance;
- 3) The longer cord should be arranged so that it does not drape over the countertop or table top where it can be pulled on by children or tripped over unintentionally.

THIS APPLIANCE IS INTENDED TO BE USED IN HOUSEHOLD ONLY

Thank you for buying this appliance. Read the instructions in this leaflet carefully and keep them within reach. Any commercial use, inappropriate use or failure to comply with the instructions, the manufacturer accepts no responsibility and the guarantee will not apply.

For your safety, this product conforms to all applicable standards and regulations (Low Voltage Directive, Electromagnetic Compatibility, Food Compliant Materials, Environment, ...).

Our company has an ongoing policy of research and development and may modify these products without prior notice.

Do not consume foodstuff that comes into contact with the parts marked with  logo.

The appliance is prohibited outside. This appliance is intended for domestic household use only. It is not intended to be used in the following applications, and the guarantee will not apply for :

- staff kitchen areas in shops, offices and other working environments;
- farm houses;
- by clients in hotels, motels and other residential type environments;
- bed and breakfast type environments.

Prevention of accidents at home

- This appliance is not intended for use by persons (including children) with reduced physical, sensory or mental capabilities, or lack of experience and knowledge, unless they have been given supervision or instruction concerning use of the appliance by an adult responsible for their safety. Children should be supervised to ensure that they do not play with the appliance.
- Accessible surface temperatures can be high when the appliance is operating. Never touch the hot surfaces of the appliance.
- Never leave the appliance plugged in when not in use.
- If an accident occurs, rinse the burn immediately with cold water and call a doctor if necessary.
- Cooking fumes may be dangerous for animals which have a particularly sensitive respiratory system, such as birds. We advise bird owners to keep them away from the cooking area.



Environment protection first !

- ① Your appliance contains valuable materials which can be recovered or recycled.
- ➔ Leave it at a local civic waste collection point.



1

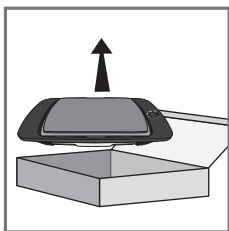

- 1 Remove all packaging materials, stickers and accessories from the inside and the outside of the appliance.

1

Never place the appliance directly on a fragile surface (glass table, tablecloth, varnished furniture, etc.) or on a soft surface such as a tea-towel.

To prevent the appliance from overheating, do not place it in a corner or against a wall.

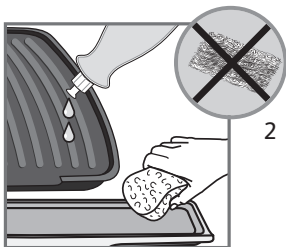

- 2 Before using for the first time, thoroughly clean the plate with warm water and dish soap.

2

Wipe over the plate using a paper towel dipped in a little cooking oil. Remove any surplus oil using a clean kitchen paper towel.

- 3 Ensure that the plate is stable and fitted correctly onto the base of the appliance.

- 4 Insert the dip tray under the base of the appliance.

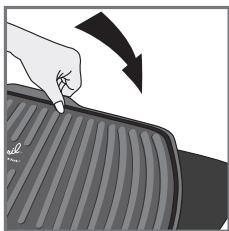

3

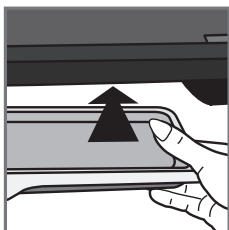

4

6

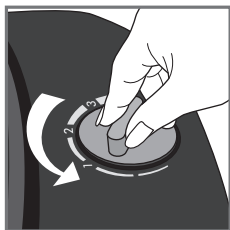

5

5-6 Place the thermostat in the minimum position before plugging in the appliance.

Fully unwind the power cord.

Make sure that the electric power supply is compatible with the power rating and voltage indicated on the bottom of the appliance.

If an extension cord is used: take all necessary precautions to prevent anyone tripping over an extension cord.

If the power supply cord is damaged, it must be replaced by the manufacturer or its service agent or a similarly qualified person in order to avoid a hazard.

The power supply cord should be regularly examined for signs of damage, and if the cord is damaged, the appliance must not be used.

On first use, there may be a slight odor and a little smoke during the first few minutes.

This appliance is not intended to be operated by means of an external timer or separate remote-control system.

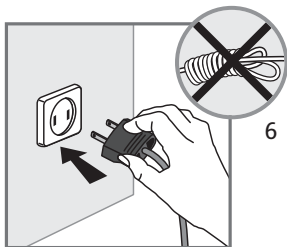

6

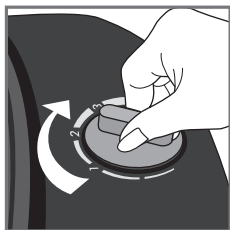

7

- 7** Preheat the appliance by selecting the desired temperature on the dial.

Do not move the appliance when in use.

Do not use aluminium foil or other objects between the plate and the food being cooked.



8

- 8-9** To preserve the non-stick properties of the coating, do not cook food in aluminium foil.

Always use a wooden or plastic spatula to avoid damaging the cooking plate.

Do not remove the dip tray while cooking. If the dip tray becomes full when cooking, let the appliance cool down before emptying.

Never leave the appliance unattended when in use.

Do not place cooking utensils on the cooking surface of the appliance



9

Never run the appliance empty.

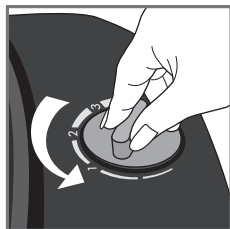

10

10-11

Place the thermostat in the minimum position before unplugging the grill.

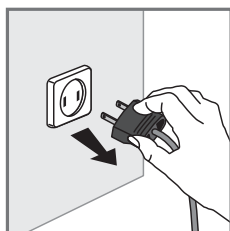

11

12-13

Check that the appliance has cooled down completely and that it is unplugged before putting it away. Let it cool down before cleaning.

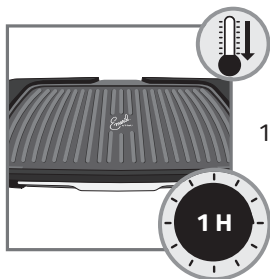

12



13

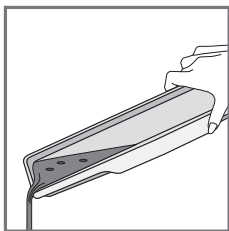

14

15-17

The cooking plate can be cleaned with a sponge, hot water and dish soap.

Do not immerse the appliance in water. Never immerse the appliance or power supply cord in water.

Never use metal scourers or scouring powder to avoid damaging the cooking surface.

Plate and juice tray are dishwasher safe.



15

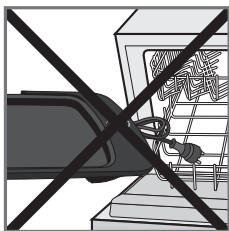

16

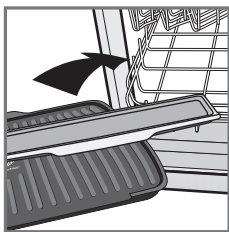

17

T-FAL* MANUFACTURER'S WARRANTY

 : www.t-fal.com

With a strong commitment to the environment, most of T-fal products are repairable during and after the warranty period. Before returning any defective products to the point of purchase, please call T-fal consumer service directly at the phone number below for repair options. Your help to sustain the environment is appreciated!

The Warranty

This product is guaranteed by T-fal for 1 year against any manufacturing defect in materials or workmanship, starting from the initial date of purchase.

The manufacturer's warranty by T-fal is an extra benefit which does not affect consumer's Statutory Rights.

The T-fal warranty covers all costs related to restoring the proven defective product so that it conforms to its original specifications, through the repair or replacement of any defective part and the necessary labor. At T-fal's choice, a replacement product may be provided instead of repairing a defective product. T-fal's sole obligation and your exclusive resolution under this warranty are limited to such repair or replacement.

Conditions & Exclusions

The T-fal warranty only applies within USA, Canada & Mexico, and is valid only on presentation of a proof of purchase. The product can be taken directly in person to an authorized service centre or must be adequately packaged and returned, by recorded delivery (or equivalent method of postage), to a T-fal authorized service centre. Full address details for each country's authorized service centre are listed on the T-fal website (www.t-fal.com) or by calling the appropriate telephone number listed below to request the appropriate postal address.

T-fal shall not be obligated to repair or replace any product which is not accompanied by a valid proof of purchase.

This warranty will not cover any damage which could occur as a result of misuse, negligence, failure to follow T-fal instructions, use on current or voltage other than as stamped on the product, or a modification or unauthorized repair of the product. It also does not cover normal tear and wear, maintenance or replacement of consumable parts, and the following:

- using the wrong type of water
- scaling (any de-scaling must be carried out according to the Instructions for use);
- ingress of water, dust or insects into the product;
- mechanical damages, overloading
- damages or bad results due to wrong voltage or frequency
- accidents including fire, flood, lightning, etc
- professional or commercial use
- damage to any glass or porcelain ware in the product

This warranty does not apply to any product that has been tampered with, or to damages incurred through improper use and care, faulty packaging by the owner or mishandling by any carrier.

The T-fal manufacturer's warranty applies only for products purchased and used in USA, Canada & Mexico. Where a product purchased in one country and then used in another one:

- a) The T-fal guarantee duration is the one in the country of usage of the product, even if the product was purchased in another listed country with different guarantee duration.
- b) The T-fal guarantee does not apply in case of non conformity of the purchased product with the local standards, such as voltage, frequency, power plugs, or other local technical specifications
- c) The repair process for products purchased outside the country of use may require a longer time if the product is not locally sold by T-fal
- d) In cases where the product is not repairable in the new country, the T-fal guarantee is limited to a replacement by a similar product or an alternative product at similar cost, where possible.

Consumer Statutory Rights

This T-fal manufacturer's warranty does not affect the statutory rights a consumer may have or those rights that cannot be excluded or limited, nor rights against the retailer from which the consumer purchased the product. This warranty gives a consumer specific legal rights, and the consumer may also have other legal rights which vary from State to State or Country to Country or Province to Province. The consumer may assert any such rights at his sole discretion

Additional information

Accessories, Consumables and end-user replaceable parts can be purchased, if locally available, as described in T-fal internet site.

U.S.A.	GROUPE SEB USA 2121 Eden Road Millville, NJ 08332
	800-395-8325

* T-fal is a registered trademark of Groupe SEB

www.t-fal.com

ref. 2017209870