

Component Checklist

VESA monitor head (x1)

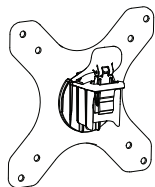

Display Mounting
Spacers (x4)



M4 x 14mm (x1)
Silver Phillips Head
Security Screw



Display Mounting Screws



M4 x 12/16/25mm (x4)
Black Phillips Head Mounting Screws

IMPORTANT INFORMATION:

! IMPORTANT - Install Systema Monitor Head as per installation instruction.

! Refer to Systema Monitor arm or Monitor Spring Arm Installation Instructions for maximum load advice.

! The manufacturer accepts no responsibility for incorrect installation.

! The Systema Monitor Head is compatible with Systema Monitor Arms: SA13, SA46, SA71 and with Systema Monitor Spring Arms: SS and SSK.

Step 1. Check Components

Check what you have received against the component checklist and hardware above.

Step 3. Install VESA monitor head

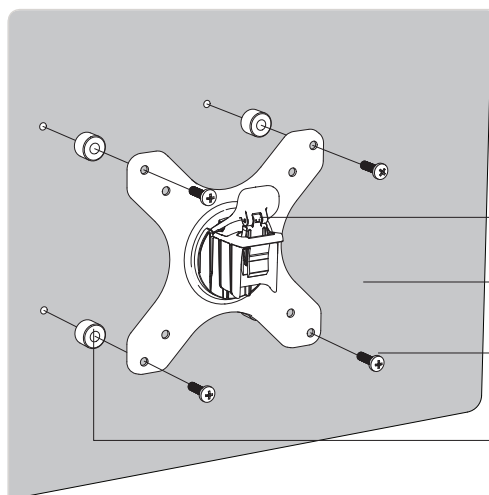

3.1 Install VESA monitor head as shown.

VESA monitor head

Screen

M4x12/16/25mm
Phillips Head Mounting Screws

Spacers (may be required for
recessed and uneven surfaces)

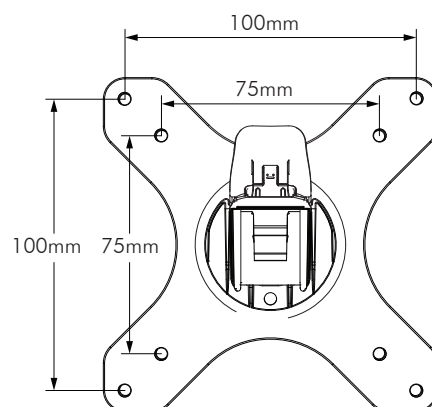

Step 4. Mount Display

4.1 Insert VESA monitor head into the receptacle in the Monitor Arm or Monitor Spring Arm Assembly.

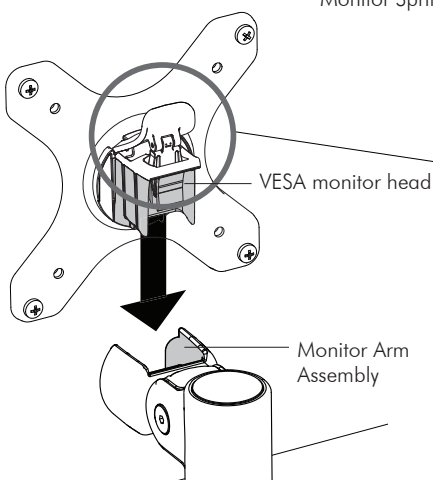

VESA monitor head

Monitor Arm
Assembly



Note: Ensure the Lever is
in the **up** position before
installation onto the Arm
Assembly.

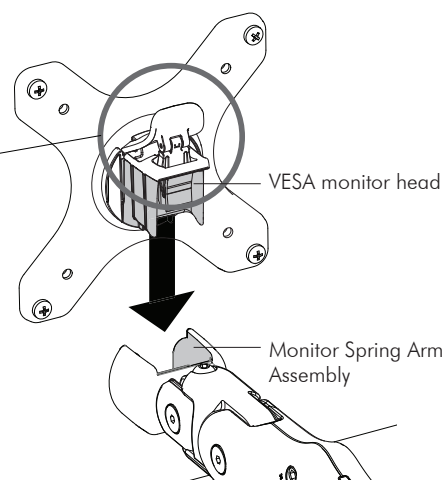

VESA monitor head

Monitor Spring Arm
Assembly

Step 4. Continued.

4.2 Ensure that the VESA monitor head sits flush within the Arm Assembly receptacle. There should be **no** gap.

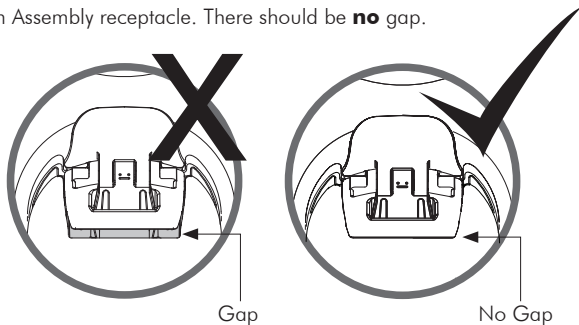

4.3 Once the VESA monitor head is sitting flush, push the lever down to secure it to the Arm Assembly.

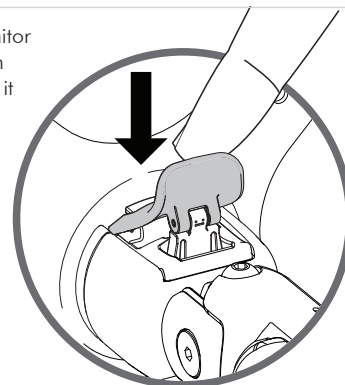

4.4 OPTIONAL SECURITY SCREW

Ensure the Monitor is supported, then loosen the Monitor head screw with the 3mm Allen Key and tilt screen up before installing the M4 x 14mm Security Screw into the Security Screw hole.

Monitor Arm

Note: Support Screen when adjusting tilt.

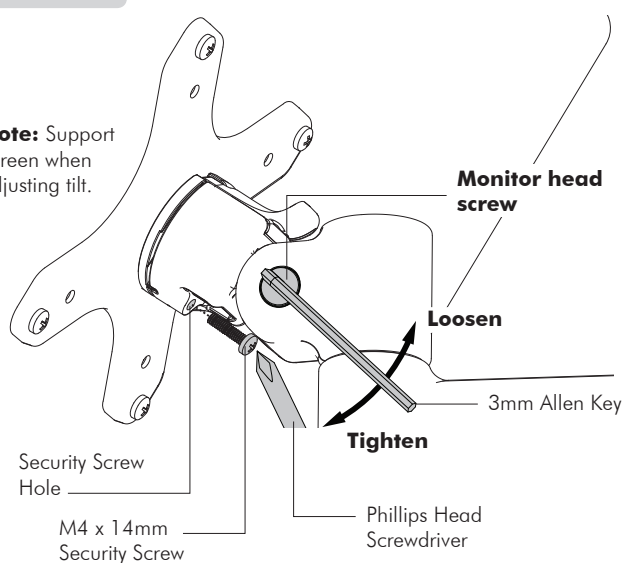

Monitor Spring Arm

Note: Support Screen when adjusting tilt.

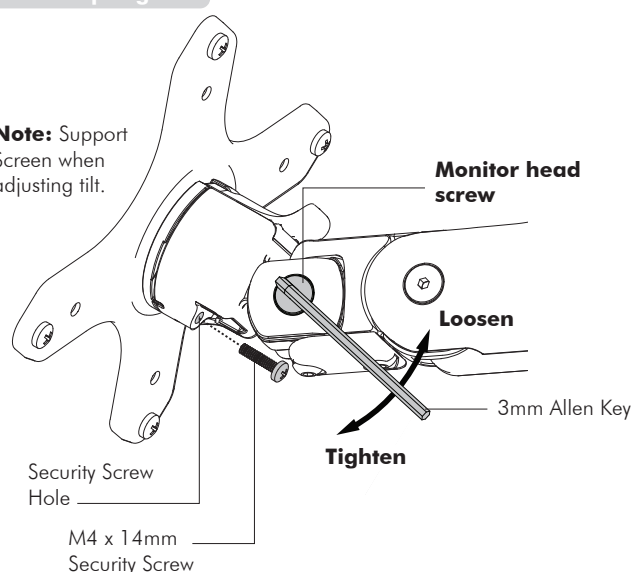

Installation Complete



No portion of this document or any artwork contained herein should be reproduced in any way without the express written consent of Atdec Pty Ltd. Due to continuing product development, the manufacturer reserves the right to alter specifications without notice. Published 20.03.14 ©