

High Power 1000mW Wi-Fi Signal Booster

(for 2.4GHz 802.11b/g/n certified devices)

SB1000

The Amped Wireless High Power 1000mW Wi-Fi Signal Booster amplifies the signal strength of your certified Wi-Fi device to deliver more wireless range and performance. Typical wireless routers, access points and adapters have wireless output powers of less than 50mW. The SB1000 replaces the removable antenna on your certified Wi-Fi device to boost the signal strength by as much as 20 times, to a staggering 1000mW of wireless power. The high gain 7dBi omni-directional antenna transmits the boosted signal in a 360 degree radius to cover your entire home or office with strong Wi-Fi coverage.



How it Works:

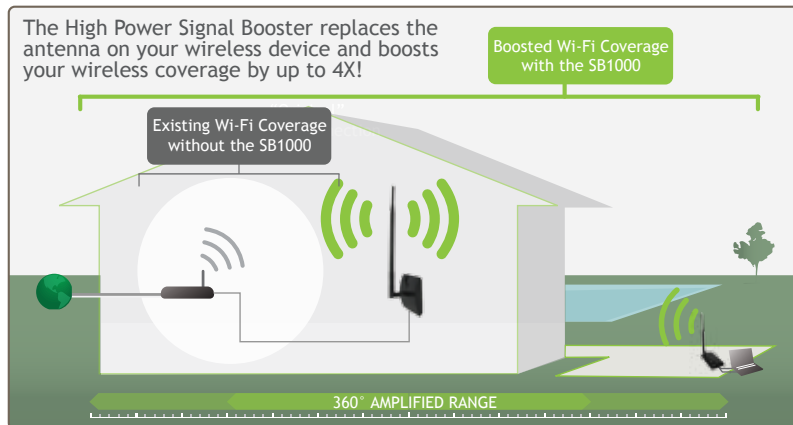

Advanced Amped Technology:

Wireless Amplifiers and High Gain Antennas:

The High Power Signal Booster features a massive 1000mW Amplifier to boost Wi-Fi transmitting and receiving strength

The SB1000 is optimally paired and tuned with a High Gain 7dBi Omni-Directional Antenna for maximized 360 degree wireless coverage.

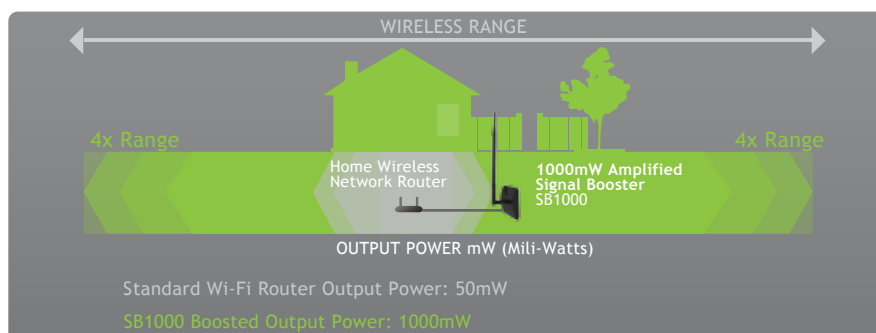

Key Features

- Plug and Play: Replaces the antenna on your certified Wi-Fi device
- Works with certified* wireless b/g/n devices with detachable antennas
- Signal filters ensure a safe, clean and Wi-Fi friendly environment
- Antenna swivels and is detachable from the base for different installation options

Wireless Coverage Pattern

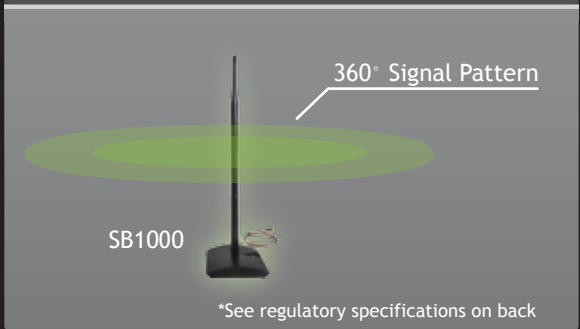

Amped Wireless Technology



Wireless Performance

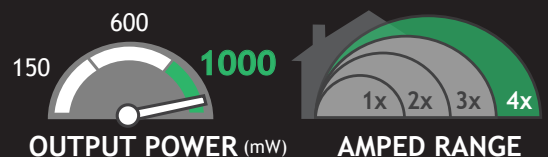

Plug & Play Setup

1 Detach the antenna from your Certified Wireless Device

2 Attach the Signal Booster to the antenna connector of your Wi-Fi device

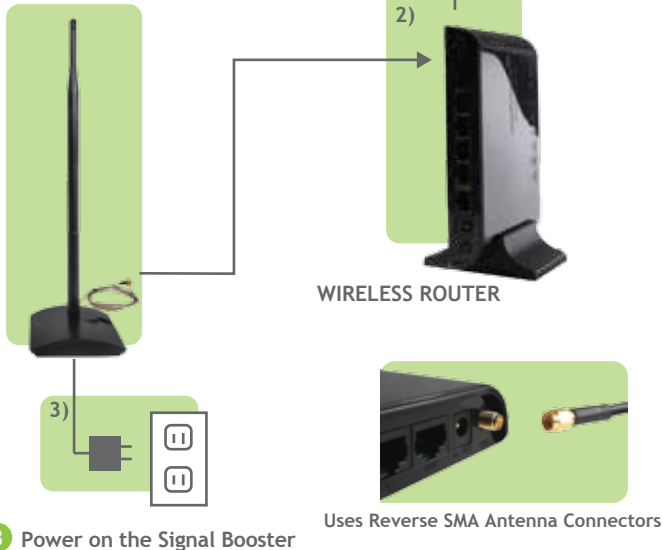

Mounting Options



Desktop

Place the antenna on any flat surface for easy placement



Wall:

Includes mounting holes and accessories to mount the antenna on any wall



Magnetic Mount:

The magnetic base allows for mounting on metal surfaces, such as the side of a computer case



Detachable Swivel Antenna:

Easy to replace and position

Product Specifications:

Wireless Standard: Works with IEEE 802.11b/g/n

Frequency Band: 2.4 - 2.48 GHz

Amplifier: **1000mW Power Amplifier**
Low Noise Amplifier

Total Output Power: **Up to 30dBm (Max)**

Receive Gain: **12dB**

Input Power Range: 1 to 19dBm

Connectors:

- Antenna Connector: Reverse SMA Jack
- Input Connector: Reverse SMA Plug
- Input Cable Length: 4 Feet

Antenna:

- **1 High Gain 7dBi Omni-Directional Antenna (Detachable)**

LED Indicators: Transmit and Receive (Blue)

System Requirements

- Certified* 2.4GHz Wireless b/g/n Device with a detachable antenna
- Reverse SMA Jack Antenna Connector (for the wireless device)

Package Contents:

- One High Power 1000mW Wireless Signal Booster with 4 foot cable
- One High Gain 7dBi Omni Directional Antenna
- One Quick Installation Guide

Certified Wi-Fi Devices

Amped Wireless High Power Wireless-150N Repeater

*Under FCC regulations, The SB1000 may only be used with Wi-Fi devices that have been certified for use with the SB1000 as a system.

** Wireless performance may vary as performance depends on many factors, including environmental conditions and installation scenarios.

Designed by Amped Wireless in the USA

Amped Wireless

13089 Peyton Dr. #C307

Chino Hills, CA 91709

www.ampedwireless.com

1(888) 573-8830