

# NEC MultiSync® EX231W

LED-backlit desktop LCD monitor ideal for corporate environments



**Maximize the eco-friendliness of your work environment.** The 23" NEC MultiSync EX231W full HD LCD monitor sets the bar for "green" displays, featuring a handful of components that lower total cost of ownership by saving energy, tracking carbon footprint emissions and minimizing packaging. In addition, this model is our lightest, thinnest and most ergonomically designed model to date; and boasts outstanding screen performance and advanced display technologies to optimize your desktop computing productivity.

**It's easy to be green.** The EX231W uses LED backlighting, which optimizes energy efficiency. Compared to previous generation NEC LCDs, this model consumes up to 52% less power overall, radiates up to 61% less heat, uses up to 15% less packaging, weighs up to 25% less, utilizes recycled plastics in its production and is free of hazardous materials such as mercury, halogen and arsenic. Other eco-friendly benefits include ECO Mode™, auto brightness, Intelligent Power Manager (IPM) and an off timer for further energy savings, a resettable carbon footprint meter for tracking the conservation of green gas emissions, and a significant reduction in packaging materials.



The EX231W's human and ambient light sensors (L) automatically detect your work conditions to determine the proper display brightness, thereby conserving power. Touch-sensitive OSD® controls (R) are integrated into the bezel, making display adjustments easier than ever.

## Features & Benefits

**LED backlight technology** provides for industry-leading low power consumption and less hazardous materials

**Height-adjust, pivot, tilt and swivel capabilities** add flexibility and comfort to your viewing preferences

**XtraView® technology** provides for some of the widest viewing angles available

**Human sensor** monitors the presence of a user in front of the display and can go into power saving mode if the user leaves

**Ambient light sensor** minimizes power consumption by automatically adjusting the brightness to the optimal setting depending on ambient lighting, screen content or both

**ECO Mode** allows you to manually adjust the display's brightness to two preset settings, including ENERGY STAR, saving more power and reducing your energy costs

**Intelligent Power Manager (IPM) system and off timer** provide innovative power-saving methods and reduce CO<sub>2</sub> emissions by shifting to a lower power consumption level or automatically powering down when the monitor is on but not in use

**Carbon footprint meter** helps track and calculate the conservation of green gas emissions via OSD and NaViSet™ Administrator

**Dynamic Video Mode** enhances video and images with real-time optimization of brightness, color and contrast

**Minimalist design**, featuring an ultra-thin bezel width (14.6mm) and depth (16.4mm), puts the focus on the screen vs. the cabinet

**Compact packaging** helps reduce paper usage, shipping costs and waste

**EPEAT Gold compliance** ensures the displays reduce hazardous waste and electricity usage, resulting in lower energy costs and increased protection for the environment

**ENERGY STAR 5.0 compliance** reduces electrical costs and lowers total cost of ownership

**NEC Display Solutions' quality and reliability** provide peace of mind with a 3-year limited parts and labor warranty (including backlight) and unrivaled customer service and technical support

The MultiSync EX231W features a 4-way ergonomic stand with capabilities of pivot (A), height-adjustment (up to 110mm) (B), tilt (C) and swivel (D), allowing you to create an ideal ergonomic display orientation for maximum viewing comfort.

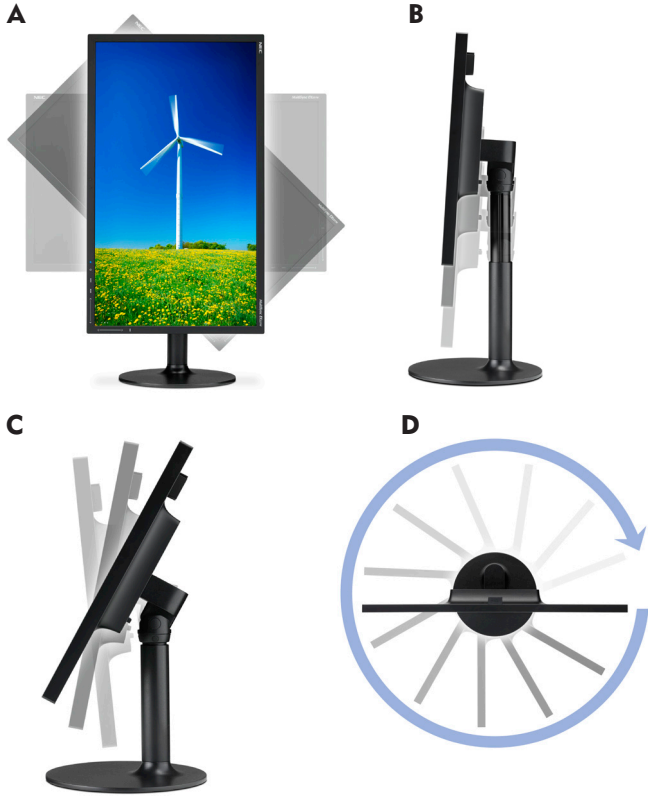

For simple transport of the EX231W, a quick release lever (E) allows you to quickly and easily remove the display from the stand, while the built-in recessed handle (F) helps avoid damage to the bezel and screen while carrying.

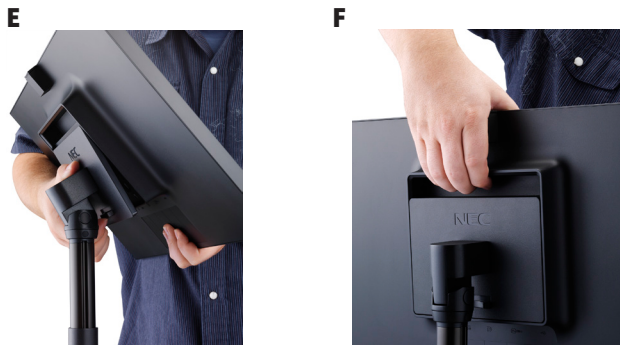

A top-mounted USB pass-through (G) allows for the easy addition of a webcam, microphone or other peripherals. The input panel (H) includes a second USB pass-through as well as a mini-AC adapter, and DisplayPort and DVI-I connections.

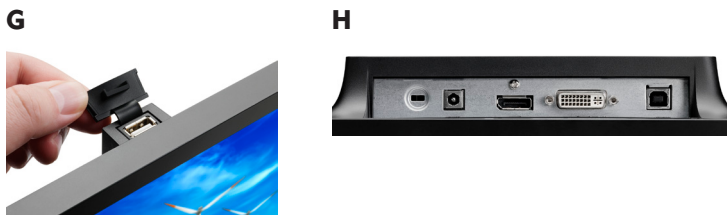

Model	MultiSync EX231W
<b>Display</b>	Viewable Image Size 23" Aspect Ratio 16:9 Pixel Pitch 0.265mm Pixels Per Inch 96 @ native resolution Brightness (typical) 250 cd/m <sup>2</sup> Contrast Ratio (typical) 1000:1 (25,000:1 dynamic) Viewing Angle (typical) 170° Vert., 176° Hor. (85U/85D/88L/88R) (CR > 5) Response Time (typical) Rapid Response (5ms) Display Colors More than 16.7million
<b>Synchronization Range</b>	Horizontal 31.5-83 KHz Vertical 56-75Hz
<b>Input Signal</b>	Video Analog 0.7 Vp-p / 75 Ohms Sync Separate Sync: TTL Level (positive/negative)
<b>Inputs</b>	DVI-I and DisplayPort
<b>Resolutions Supported</b>	720 x 400 @ 70 Hz 640 x 480 @ 60-75 Hz 800 x 600 @ 56-75 Hz 832 x 624 @ 75 Hz 1024 x 768 @ 60-75 Hz 1152 x 864 @ 75 Hz 1152 x 870 @ 75 Hz 1280 x 768 @ 60-75 Hz 1280 x 960 @ 60 Hz 1280 x 1024 @ 60-75 Hz 1360 x 768 @ 60 Hz 1440 x 900 @ 60 Hz 1440 x 1050 @ 60-75 Hz 1600 x 1200 @ 60 Hz 1920 x 1080 @ 60 Hz
<b>Native Resolution</b>	1920 x 1080 @ 60 Hz
<b>Additional Features</b>	Ultra-thin frame (bezel), widescreen format, USB pass-through, ambient light sensor, human sensor, ECO Mode, carbon footprint meter, cost meter, integral power meter, Dynamic Video Mode, hot key, OSD turnoff, OSD lockout, cable management, sRGB, HDCP, AccuColor control, No Touch Auto Adjust, DDC/CI, NaViSet software, Plug and Play (VESA DDC 2B), VESA DPMS power management, IPM system, off-timer, touch OSD user control, quick release stand, EPEAT Gold, ENERGY STAR 5.0, RoHs compliancy
<b>Voltage Rating</b>	AC 100-120V / AC 220-240V
<b>Power Consumption</b>	Typical 31W Power Savings Mode 0.37W ECO Mode ON 16W
<b>Dimensions (W x H x D)</b>	Net (with stand) 21.3 x 15.8-20.1 x 8.5 in. / 540.2 x 401.3-511.3 x 215mm Net (without stand) 21.3 x 12.5 x 1.9 in. / 540.2 x 318.3 x 47.7mm
<b>Weight</b>	Net (with stand) 9.3 lbs. / 4.2 kg Net (without stand) 6.2 lbs. / 2.8 kg
<b>VESA Hole Configuration Specifications</b>	100 x 100mm
<b>Environmental Conditions</b>	Operating Temperature 5-35°C / 41-95°F Operating Humidity 20-80% Operating Altitude 2000m / 6562 ft. Storage Temperature -10-60°C / 14-140°F Storage Humidity 10-85% Storage Altitude 12,192m / 40,000 ft.
<b>Limited Warranty</b>	3 years parts and labor, including backlight
<b>Technical Support</b>	M - F (7am - 7pm CST)



MultiSync and XtraView are registered trademarks and ECO Mode and Rapid Response are trademarks of NEC Display Solutions. All other brand or product names are trademarks or registered trademarks of their respective holders. Product specifications subject to change. 10/10 ver. 1.

©2010 NEC Display Solutions of America, Inc. All rights reserved.

**NEC Display Solutions**  
500 Park Boulevard, Suite 1100  
Itasca, IL 60143  
866-NEC-MORE

